

liftturnmove



Winch, Cranks & Jacks

Hand Winches - Standard & Stainless Steel

Electric Winches

Rope Pulleys

Hand Operated Gear Boxes

Cranks

Jacks - Cable Drum Jacks

- Wall Mounted

- Sluice Gate



LTM

LTM - Lift Turn Move Ltd, established in September 2004, is based in Birkenhead, Wirral and is an independent company owned and operated by the people who run the business day by day. This ensures decisions are made swiftly and customer service is top priority.

John Jones, David King and Dave Ward own the business and are joined by Jenny Hobday, Dan Holme, Alison Jones, James Porter, Dawn Gerrard and Carl Hamlet in sales and support roles.

Peter Ashford and Gwyn Davies have outside sales roles on the industrial side of the business. Dave Ward is joined in the engineering workshop by Geoff Cromwell, Jim Marshall and 2 other lifting engineers. Wade Taylor manages the warehouse.

LTM has over 200 man years of Lifting and Handling Equipment experience.

Markets & products

An extensive range of equipment is available from LTM including many 'off the shelf problem solvers', if you have any unusual requirements we will be pleased to source equipment for you- we have extensive knowledge of 'who makes what' in Europe .

Lift Turn Move operates in two separate but related business areas. We supply an extensive range of equipment for entertainment industry lifting applications. This includes the Lodestar electric chain hoist and other assorted equipment.

We also supply Industrial Lifting Equipment- the area in which we started. If you look at the range of equipment we offer, you will see many problem solving winches and rope pulleys together with an extensive range of stainless steel winches, gearboxes and cranks. We offer an extensive range of equipment at competitive prices.

We also supply an extensive range of Lifting Equipment for use in the Professional Entertainment Industry. This includes Electric Chain Hoists and other assorted rigging equipment including Hoist Controllers which we build ourselves.

A full range of rigging accessories, including Steels, Shackles, Roundslings, Softslings, STAC chain and Beam Clamps are also available from stock. Please see our separate literature.

For further information see www.ltmtrucks.com, www.winchshop.co.uk or www.liftturnmove.co.uk

Services

In addition LTM offers repairs and routine servicing on Electric Chain Hoist. This can either be done at our workshop or alternatively we offer this service at your premises.

We undertake site installation, testing and commissioning work on all of the products we offer for sale. We can also install equipment from other manufacturers.

Our engineering staff, as well as being time served engineers - both Mechanical and Electrical, hold LEEA (Lifting Equipment Engineers' Association) qualifications.

Our processes are audited and checked by LEEA to ensure we undertake our operations to meet the latest regulations and standards.

Training

LTM continues the work we started in the provision of Chain Hoist Training Schools for owners and users. Training courses take place on a regular basis, both in house and on your premises.



Why use LTM

We pride ourselves on fast response and delivery; we hold an extensive range of equipment at our premises and orders and repairs are turned around at speed.

We give honest opinions on solutions that suit your needs and we offer the right solution.

LTM understands the needs of demanding and rapidly moving industries where service is critical.

Members of the LTM sales and workshop team are LEEA (Lifting Equipment Engineers Association) qualified; we hold recognised qualifications relating to the products we sell and service - only a handful of UK companies in the entertainment sector can say the same!

We believe you will find our service helpful, prompt and efficient. Please let us quote for your requirements.

When you deal with LTM, you get experience, problem solving and most of all flexibility - free of charge.

Contact Details

LTM- Lift Turn Move Ltd
Unit 6, Appin Rd,
Argyle Industrial Estate,
Birkenhead,
Wirral, UK.
CH41 9HH

Tel: +44 (0)151 649 0469
Fax: +44 (0)151 649 0099
Email: sales@winchshop.co.uk
www.winchshop.co.uk

Sales Office Contacts:

James Porter 07852 928 798
Jenny Hobday 07852 928 790
Dan Holme 07737 939 124
John Jones 07831 499 229
David King 07973 123 835

jamesporter@liftturnmove.co.uk
jennyhobday@liftturnmove.co.uk
danholme@liftturnmove.co.uk
johnjones@liftturnmove.co.uk
davidking@liftturnmove.co.uk

Opening Hours: Monday - Friday 9.00am - 5.00pm
the office is normally open outside these times

We use various methods of delivery and can deliver more or less whenever you need.



Page	Reference	Lifting Capacities	Gearing	Mounting	Construction	Finish	Special Features
2	LTM- who we are.						
3	Index						
Hand Winches, Spur Gear, Wall Mounted							
4	Hand Winch HA- AG	45/100 kg	Spur	Wall	Aluminium	Painted	Powder Coat finish
5	Hand Winch HA- SW	80/ 125 kg	Spur	Wall	Steel	Plated	125kg also available in Stainless Steel
6	Hand Winch HD- SG	63/ 125/ 250 kg	Spur	Wall	Aluminium	Painted	Enclosed brake
7	Hand Winch HA- SG	300/ 500/ 750/ 1000/ 2000/ 3000 kg	Spur	Wall	Steel	Painted or Plated	Plated version available
8	Hand Winch HA- SGS	250/ 500 kg	Spur	Wall	Steel	Painted	For use in high security areas - removable crank
Hand Winches, Spur Gear, Base or Wall Mounted							
9	Hand Winch HA- WV	300/ 500 kg	Spur	Wall	Steel	Plated	Stainless version available
9	Hand Winch HA- KV	300/ 500 kg	Spur	Base	Steel	Plated	Stainless version available
10, 11	Hand Winch GO- AFD	190/ 340/ 500/ 650/ 900/ 1180/ 1994 kg	Spur	Base or wall	Steel	Plated	Enclosed gearing
12	Hand Winch PSL- LBT	350/ 650/ 1350 Kg	Spur	Base	Steel	Plated	
13	Hand Winch F- QW	100/ 250/ 400/ 750/ 1100/ 1700 kg	Spur	Base	Steel	Painted	Free Wheeling Feature
14	Hand Winch-WI- SD	650/ 1250/ 3000 kg	Spur	Base	Steel	Plated	Special brake can be loaded both sides
Hand Winches- Stainless Steel							
15	Hand Winch- GO- AFID	190/ 340/ 500 / 650/ 900 kg	Spur	Base or wall	Stainless Steel		
16	Hand Winch HA- WE	300/ 500 Kg	Spur	Wall	Stainless Steel		
16	Hand Winch HA- KE	300/ 500 Kg	Spur	Base	Stainless Steel		
Hand Winches- Worm Geared							
17	Hand Winch GO- CS	100/ 200/ 300 kg	Worm	Wall or base	Steel	Painted	Low cost. Winch with webbing option
18, 19	Hand Winch G- WG	250/ 500/ 1000/ 1500/ 2000/ 3000/ 5000 Kg	Worm	Wall	Steel	Painted or Plated	
20	Hand Winch K- WB	250/ 500/ 750 Kg	Worm	Wall	Cast Iron	Painted	
21	Hand Winch K-WB to German BGV C1 regulation	250/ 400/ 650 Kg	Worm	Wall	Cast Iron	Painted	BGV C1 standard
Hand Winches- Special Applications							
22	G- TL	150 kg	Spur	Wall	Steel/ Plastic	Painted	ABS cover. For basketball nets
23	HA- WM	250/ 400/ 500 Kg	Worm	Wall	Steel	Painted	Low Cost. For truck spare wheels
24	HA- LW	2000kg	Spur	Base	Cast Iron	Painted	With removable gearbox. For lashing loads
Standard Range Electric Winches							
25, 26	Electric Winches HD- EL	125- 2000 Kg					1 or 3 ph power supply, economy range
27, 28	Electric Winches HD-EW	500- 10,000 Kg					3 ph power supply
Standard Range Pneumatic Winches							
29	Pneumatic Winches HD-PEL	250- 2000 Kg					Economy range
30	Pneumatic Winches HD-PEW	500- 10,000 Kg					
Rope Pulleys							
31	Type 1a- with Bronze Bush	100- 200 mm Diameter			Cast Iron	Painted	
31	Type 2- With Bracket	140- 250 mm Diameter			Cast Iron	Painted	
31	Type 5- Stainless Steel with Bracket	100 mm Diameter			Stainless Steel		
Other Equipment							
32	Gearbox HA- GB	200/ 600/ 1200/ 1800 Nm			Steel		
33	Cranks and brakes	DS, DSK, Siku, Sin			Steel		
34	Winch Information						
35	Notes						

T.B.C.

Hand Winch Type HA-AG



Lifting capacity 45 kg or 100 kg for wall mounting

- Hand operated winches designed for light duty application raising blinds, shutters, clothes lines and chandeliers, not designed for industrial applications
- Aluminium die-cast construction, corrosion resistant parts and powder coated paint finish
- Self locking
- Quiet running with low crank effort, removable crank and low weight

Specification

Lifting capacity 1st layer	kg	45	100
Rope diameter	mm	2	3
Rope Capacity Total	m	12	8
Ratio		1:1	3:1
Lift per crank turn	mm	96	38
Required Effort	daN	80	60
Weight	kg	1	2.1

Dimensions (mm)

Capacity	kg	Metric		Imperial
		45	100	lbs
A	mm	142.5	200	in
B	mm	103.5	103.5	in
C	mm	170	180	in
D	mm	122	178	in
E	mm	83.5	83.75	in
F	mm	155	155	in
G	mm	100	150	in
H-Rope Slot	mm	20x5	20x5	in
J	mm	83.5	95	in
K	mm	8	9	in
L	mm	23	30	in
M	mm	65	80	in
N	mm	5	5	in

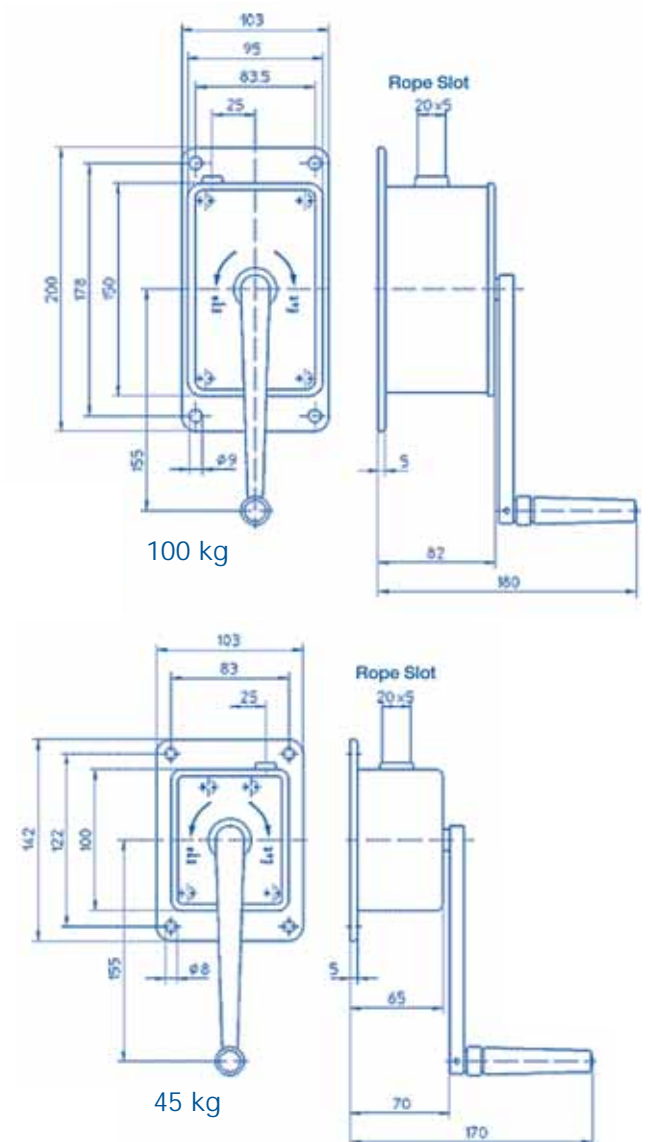



Hand Winch Type HA-SW



125 kg unit is also available as a Stainless Steel Winch

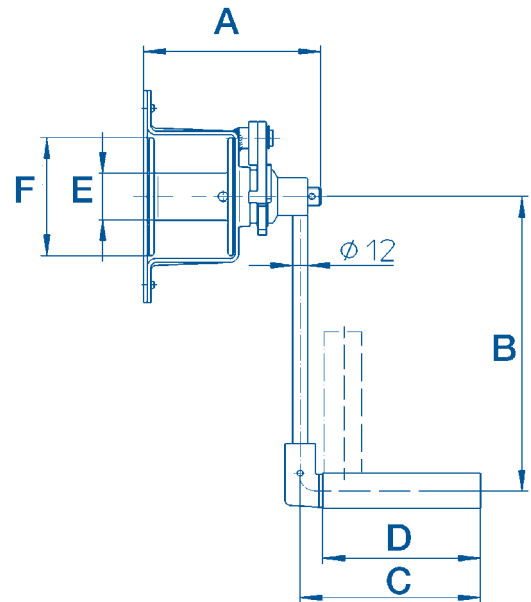
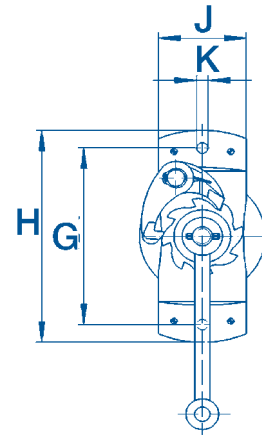

Lifting capacity 80 kg - 125 kg for wall mounting

- Compact unobtrusive hand winches
- Pressed steel, zinc plated
- Easy, Safe operation
- Corrosion resistant
- With automatic ratchet type brake – self sustaining
- Stainless Steel version available – 125 kg

Specification

Lifting capacity 1st layer	kg	80	125
Lifting Capacity last layer	kg	40	64
Rope diameter	mm	3	4
Rope Capacity 1st Layer	m	2.1	1.5
Rope Capacity Total	m	20	15
Number Of Layers		6	6
Ratio		1:1	1:1
Lift per crank turn	mm	135	135
Required Effort	daN	140	140
Duty Class to DIN 15020		1Em	1Em
Weight	kg	2.5	2.5

Dimensions (mm)

Capacity (kg)	Kg	80	125
A	mm	140	140
B	mm	160	250
C	mm	105	144
D	mm	85	126
E	mm	40	40
F	mm	100	100
G	mm	150	150
H	mm	180	180
J	mm	70	70
H	mm	9	9



Hand Winch Type HD-SG



Lifting capacity 63 – 250 kg for wall mounting

- Solid enclosed aluminium housing
- Silent, enclosed load pressure brake with automatic adjustment
- Removable winch handle
- Rope outlet in any direction
- Complies with BS EN 13157

Specification

Lifting capacity 1st layer	kg	63	125	250
Lifting capacity last layer	kg	63	125	140
Rope diameter	mm	3	3	4
Rope capacity 1st layer	m	2	2	1.4
Rope capacity total	m	20	20	15
Number of layers		6	6	6
Ratio		1:1	1:1	2.75:1
Lift per crank turn	mm	135	135	57
Required effort	kg	10	12	16
Weight	kg	3	3	5

Dimensions (mm)

Capacity (kg)	63	125	250
A	130	130	178
A1	110	110	134
B	243	270	270
B1	116	116	143
B2	90	90	90
B3	14	14	12
B4	51.5	51.5	81
C	130	130	247
C1	110	110	221
C2	55	55	53
C3	150	250	250
D	8.5	8.5	10.5
Drum Ø	40	40	46
Drum length	50	50	44

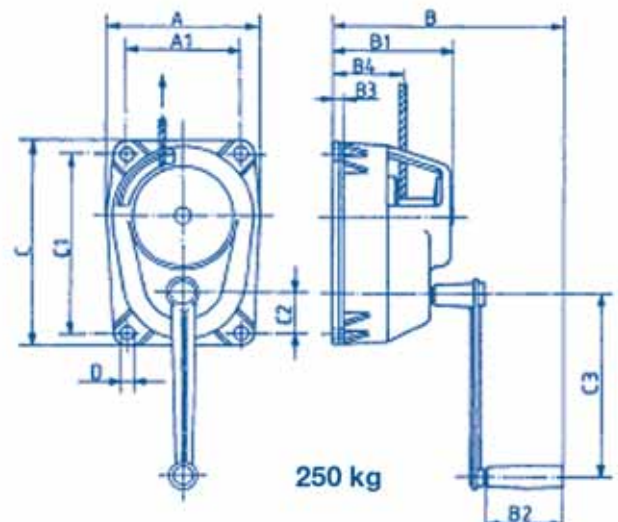
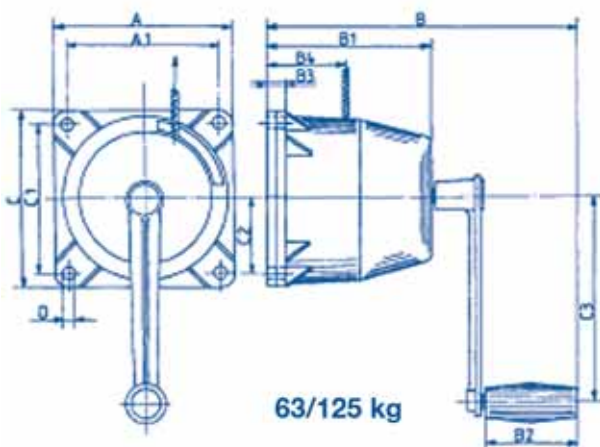



Hand Winch Type HA-SG



Lifting capacity 300 kg to 3000 kg for wall mounting

- Robust spur gear hand winches with a high degree of safety
- Self locking, blow-back safety crank with folding handle and load reaction Siku style brake
- Maintenance free bearings, corrosion resistant
- Painted finish as standard
- Zinc plated finish available on capacities 300kg, 500kg, 750kg and 1000kg
- Complies with BS EN 13157

Specification

Lifting capacity 1st layer	kg	300	500	750	1000	2000	3000
Lifting Capacity last layer	kg	203	330	580	750	1700	2500
Rope diameter	mm	6	6.5	8	9	12	13
Rope Capacity 1st Layer	m	2.7	2.1	3.7	3	3.6	2.9
Rope Capacity Total	m	11	10	12	10	8	7
Number Of Layers		4	4	4	4	2	2
Ratio		3.2:1	7.4:1	12.25:1	18.37:1	25.7:1	42.8:1
Lift per crank turn	mm	74	30	28	19	16	10
Required Effort	N	190	210	200	180	320	300
Duty Class to DIN 15020		1Em	1Em	1Em	1Em	1Em	1Em
Weight	kg	10	10	14	15	23	32

Dimensions (mm)

Capacity (kg)		300	500	750	1000	2000	3000
A	mm	209	209	263.2	263.2	271.5	348.5
B	mm	170	170	250	250	180	220
C	mm	200	200	290	290	220	260
D	mm	270	270	250	250	280	380
E	mm	300	300	290	290	330	442.5
F	mm	96	96	125	125	250	255
G	mm	130	130	130	130	250	250
H	mm	70	70	102	102	120	120
I	mm	250	250	250	250	300	300
J	mm	63	63	90	90	126	126
K	mm	89	89	145.7	145.7	161.5	223.5
L	mm	270	270	299	299	550	550

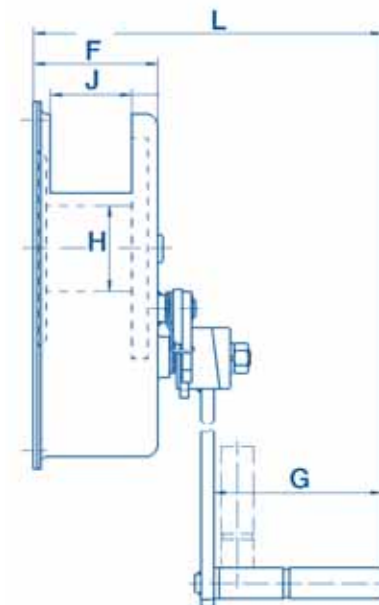
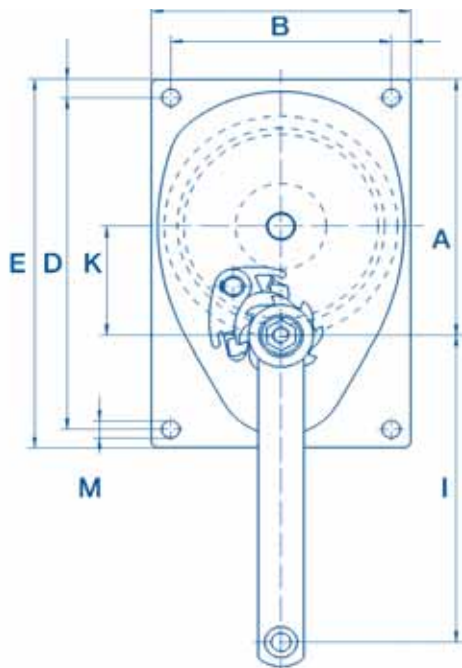
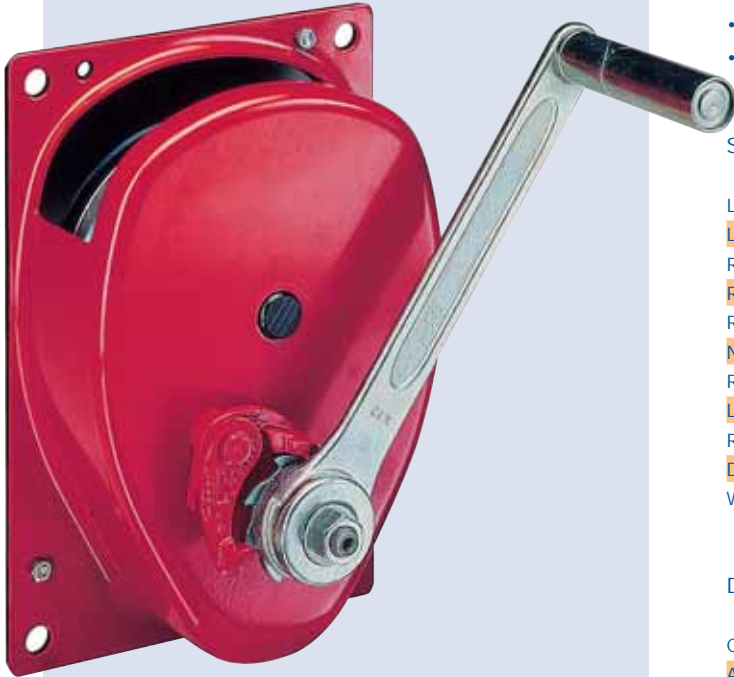



Hand Winch Type HA-SGS



Lifting capacity 250 kg or 500 kg for wall mounting

- Removable crank and handle fits either side front or back – this avoids unintentional operation – useful in non secure areas
- Easily installed on flat surfaces - unobtrusive
- Internal automatic load brake, high security with a slack rope inhibitor
- Quiet in operation
- Painted Finish
- Complies with BS EN 13157

Specification

Lifting capacity 1st layer	kg	250	500
Lifting Capacity last layer	kg	162	331
Rope diameter	mm	5	6.5
Rope Capacity 1st Layer	m	2.7	2.1
Rope Capacity Total	m	15	10
Number Of Layers		6	6
Ratio		5.06:1	9.2:1
Lift per crank turn	mm	47	25
Required Effort	daN	120	140
Duty Class to DIN 15020		1Em	1Em
Weight	kg	12	12

Dimensions (mm)

A mm	200
B mm	170
C mm	300
D mm	270
E mm	88
F mm	105
G mm	51
H mm	26
J mm	97
K mm	252

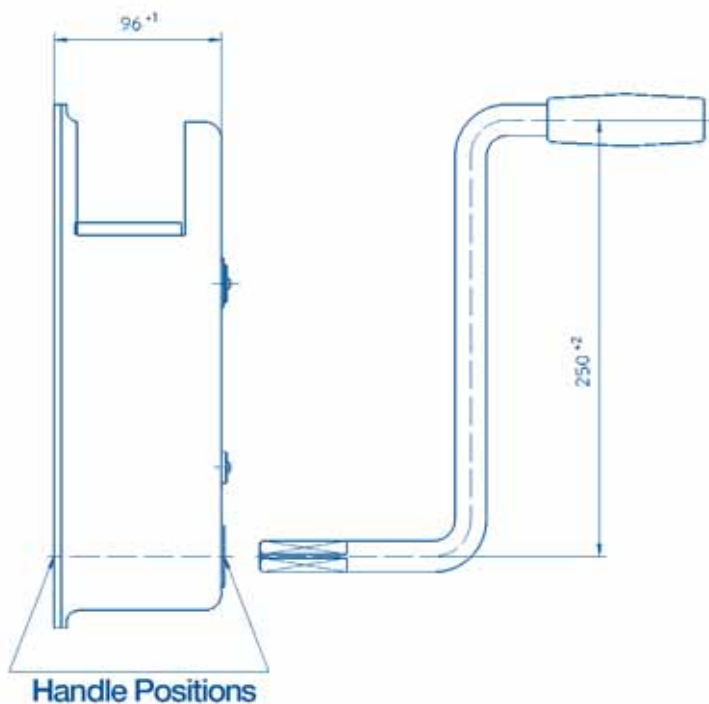
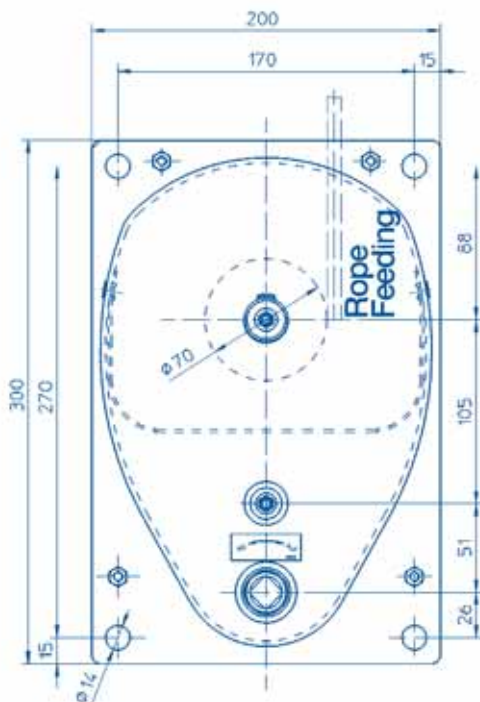



Hand Winch Type HA-WV, HA-KV



Lifting capacity 300 kg or 500 kg for wall mounting (WV) or base mounting (KV)

- Available in 2 versions – wall mounting (WV) or base mounting with mounting frame (KV)
- Innovative winch with large rope capacity
- Corrosion resistant zinc plated with fully enclosed gears and brake encased in plastic cover
- Self locking internal brake
- Lightweight and compact
- Folding crank
- Quiet in operation
- Stainless Steel version available – see page 15

Specification

Lifting capacity 1st layer	kg	300	500
Lifting Capacity last layer	kg	185	300
Rope diameter	mm	4	5
Rope Capacity 1st Layer	m	3.4	2.6
Rope Capacity Total	m	29	22
Number Of Layers		6	6
Ratio		3:1	4:5
Lift per crank turn	mm	64	46
Required Effort	daN	160	200
Duty Class to DIN 15020		1Em	1Em
Weight	kg	5	5

Dimensions (mm)

Capacity (kg)	300	500
A	337	337
B	170	170
C	135	135
D	105	105
E1	192	200
F	83	65
F1	93	84.5
G	160	160
H	250	250
J	130	130
K	140 ?	140
L	60	60
MØ	11 ?	11
NØ	13	13

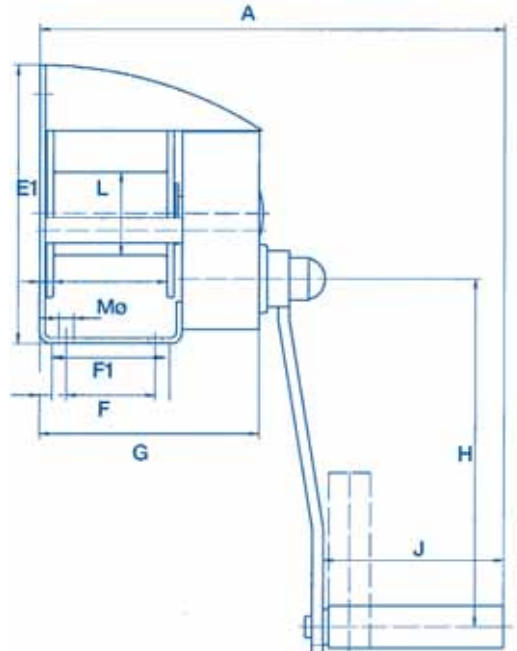
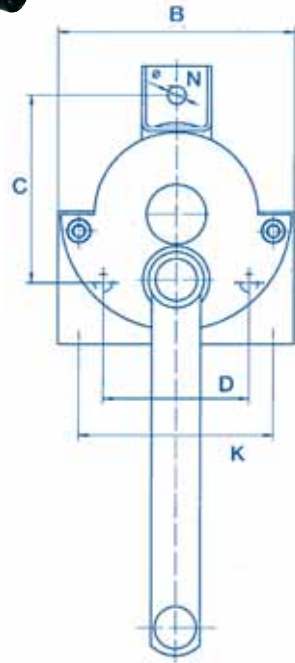



Hand Winch Type GO-AFD



Lifting capacity 190 kg - 1994 kg

- Column or base mounting
- Lightweight- inexpensive
- High efficiency through spur gearing
- Smooth running
- All components are zinc plated
- Automatic load pressure brake
- Enclosed and protected stamped gears
- For wire rope or webbing
- Complies with BS EN 13157

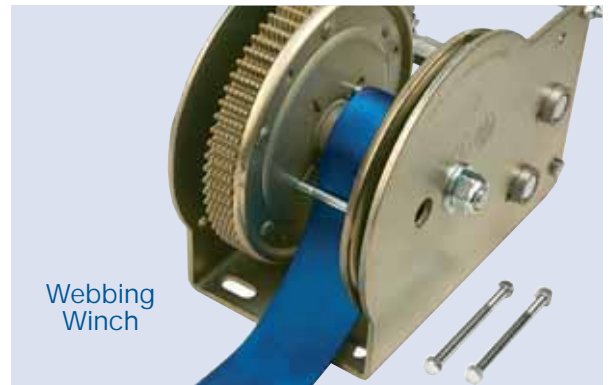

Specification - Wire Rope Winches

Winch Type		4AFMD	4AFD	6AFD	8AFD	12AFD	20AFD	30AFD
Lifting capacity 1st layer	kg	190	340	500	650	900	1180	1994
Lifting capacity last layer	kg	80	190	240	270	490	650	1419
Rope diameter	mm	3	4	5	6	7	8	9
Rope capacity 1st layer	m	0.57	1.94	1.73	1.7	1.76	2.0	3.6
Rope capacity total	m	8	12	14	19	13	10	13
Drum diameter	mm	27	40	45	54	63	76	80
Number of rope layers		8	4	5	7	5	4	2
Gear ratio		2.57:1	2.57:1	3.5:1	4.85:1	9.71:1	9.71:1	21.85/1
Lift per crank turn (1st layer)	mm	37	54	45	39	23	25	13
Required effort	kg	15	24	24	23	25	19	24
Minimum load for brake function	Kg	10	10	10	10	10	10	50
Rolling load capacity on a 30% incline	Kg	350	500	750	850	1500	2500	3664
Number of winches per box		10	8	6	4	3	3	1
Weight	kg	2.2	2.7	3.7	5.5	7.4	7.8	13.7

Specification - Webbing Winches

Winch Type		4 AFDPS	6 AFDPS	8 AFDPS	12 AFDPS
Lifting capacity - 1st layer	kg	340	500	650	800
Lifting capacity - last layer	kg	120	200	250	300
Webbing size	mm	50	50	50	50
Drum diameter	mm	25	22	28	28

Dimensions See Page 11





Hand Winch Type PSL-LBT



Lifting capacity from 350 kg to 1350 kg

- Column or base mounting
- Light weight
- High efficiency through spur gearing
- Smooth-running
- All components are zinc plated
- Automatic load pressure brake prevents unintentional lowering of the load
- Enclosed solid gears
- Complies with BS EN 13157

Specification

Lifting capacity 1st layer	kg	350	650	1350
Lifting capacity last layer	kg	170	290	480
Wire rope diameter	mm	4	6	7
Wire rope capacity 1st layer	m	2.0	1.0	1.0
Wire rope capacity total	m	20	20	26
Number of layers		7	8	10
Drum diameter	mm	36	63.5	63.5
Lift per crank turn	mm	125	55	45
Required effort	kg	25	22	24
Weight	kg	4.8	7.3	12.1

Dimensions (mm)

Capacity (kg)	350	650	1350
A	-	232	272
B	155	192	266
C	-	100	138
D	75	58	75
E	-	100	78
F	175	170	240
G	290	310	310
H	190	198	198
I	-	134	134
J	80	52	52
K	250	250	320
L	111	93	95
M	61	55	55

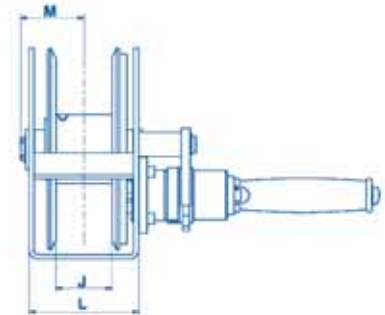
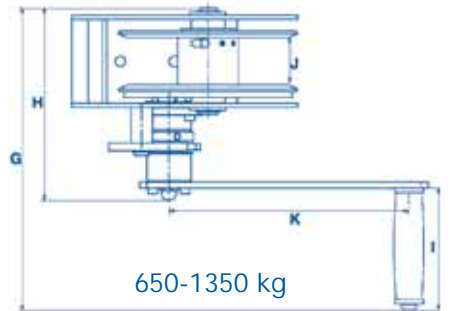
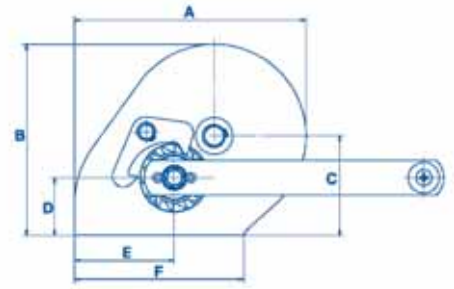

350 kg

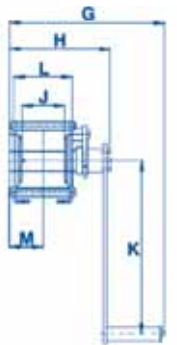
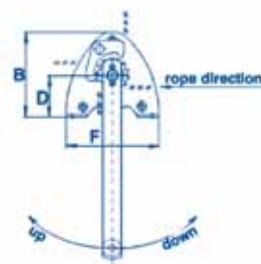



Hand Winch Type F-QW

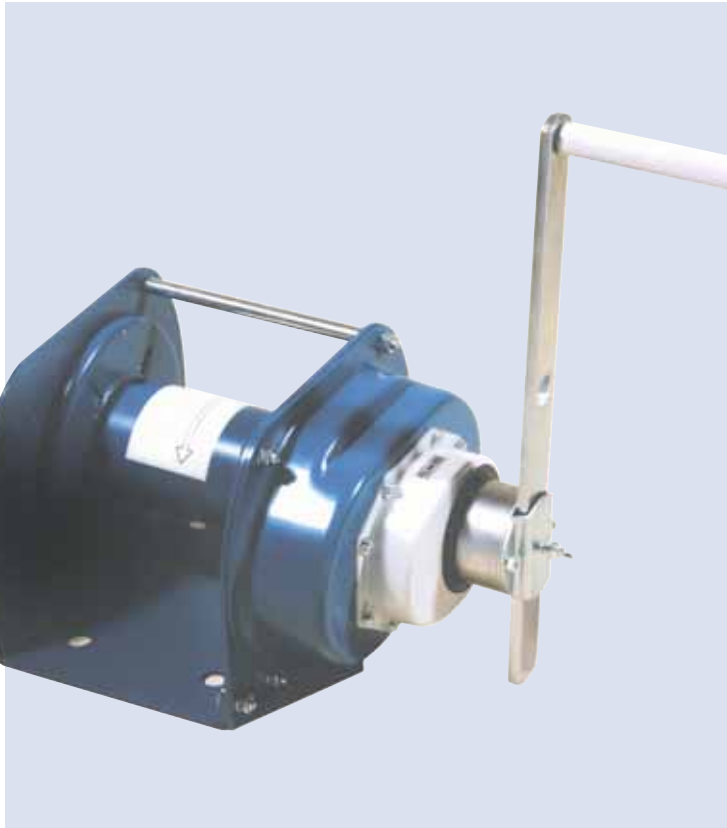

Lifting capacity 100 kg – 1700 kg for column or base mounting.

- A range of spur gear winches suitable for lifting, lowering and pulling applications
- Safe and reliable with double tipped brake pawl
- Especially suited for vehicle winch or trailer applications
- The QW winch will freewheel when unloaded; this feature can be removed if required
- Painted finish

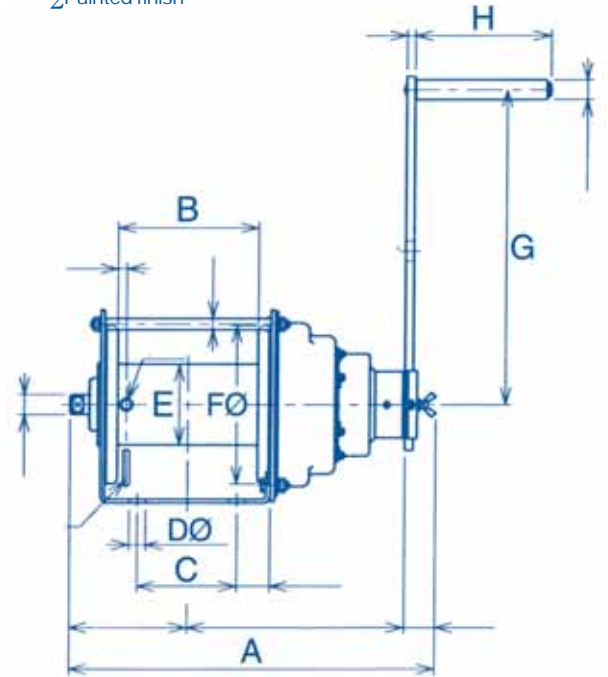

Specification

Lifting capacity 1st layer	kg	100	250	400	750	1100	1700
Lifting Capacity last layer	Kg	51	141	245	452	733	1291
Rope diameter	mm	4	5	6	8	10	12
Rope Capacity 1st Layer	m	4	5	5	5	6	7
Rope Capacity Total	m	40	40	30	30	30	20
Number Of Layers		7	6	5	5	4	3
Ratio		1:1	2.88:1	4.33:1	12.2:1	22.2:1	28.8:1
Lift per crank turn	mm	163	71	55	25	17	16.5
Required Effort	daN	11.5	9	11	10	10	15
Drive Group to DIN 15020		1Em	1Em	1Em	1Em	1Em	1Em
Weight	Kg	7	12	13	19	26	46

Dimensions (mm)

Capacity (kg)	100	250	400	750	1100	1700
A	276.5	362.5	362.5	403.5	448	509
B	4117	150	150	155	195	205
C	80	100	100	80	155	155
D	11	15	15	18	18	18
E	48	60.5	70	89.1	110	139
F	110	125	140	175	190	230
G	240	350	350	350	350	350
H	150	150	150	150	150	150
I	160	220	245	266	300	362
J	147	174	182	214	231	296
K	35	45	57.5	48	65	96
L	90	130	130	170	170	170
M	35	45	57.5	48	65	93

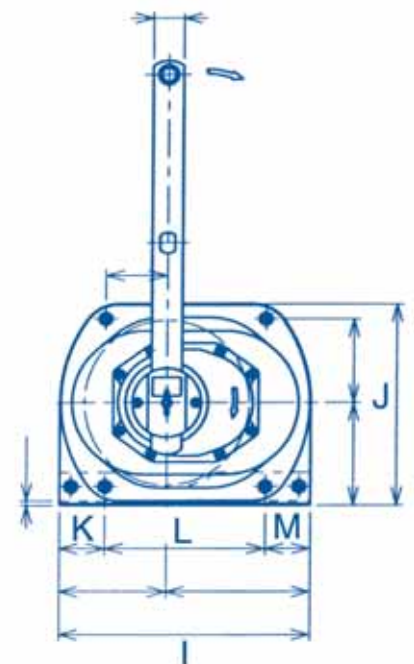



Hand Winch Type GO-AFID

Stainless Steel



Lifting capacity 190 kg - 900 kg

- Column or base mounting
- Stainless Steel 316L material
- Lightweight
- Smooth running, high efficiency through spur gearing
- Automatic load pressure brake
- Stamped gears- with gear protection
- Complies with BS EN 13157
- For wire ropes or webbing

Specification

Winch Type		4AFMID	4AFID	6AFID	8AFID	12AFID
Lifting capacity 1st layer	kg	190	340	500	650	900
Lifting capacity last layer	kg	80	180	240	270	490
Rope diameter	mm	3	4	5	6	7
Rope capacity 1st layer	m	0.57	1.94	1.73	1.7	1.76
Rope capacity total	m	8	12	14	19	13
Drum diameter	mm	27	36	45	54	63
Numbers of rope layers		8	4	5	7	5
Gear ratio		2.57:1	2.57:1	3.5:1	4.85:1	9.71:1
Lift per crank turn	mm	37	54	45	39	23
Required effort	kg	15	24	24	23	25
Minimum load for the brake function	Kg	10	10	10	10	10
Rolling load capacity on a 30% incline	Kg	450	500	750	850	1500
Weight	kg	2.2	2.8	4.4	5.2	7.6

Dimensions

See Page 11

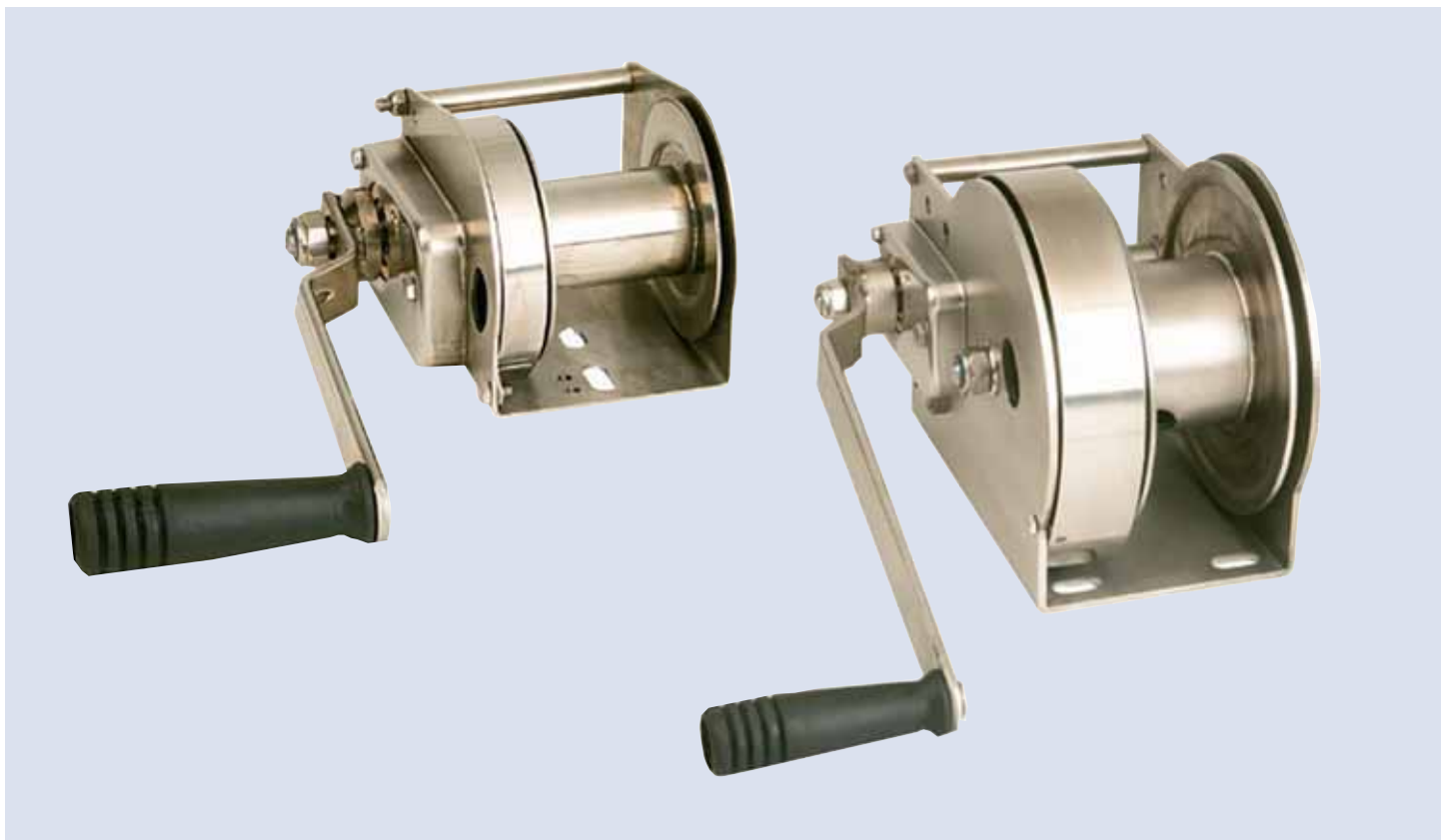



Hand Winch Type HA-WE/HA-KE

Stainless Steel



Wall mounted (WE)

Lifting capacity 300 kg or 500 kg for wall mounting (WE) or base mounting (KE)

- Corrosion resistant Stainless Steel with gears protected by plastic casing
- Large rope capacity
- Self locking internal brake with proven security concept
- Lightweight and compact shape, folding crank, fully enclosed gears and brake
- Quiet in operation
- Available in 2 versions – wall mounting (WE) or base mounting (KE) with mounting bracket



Base mounted (KE)

Specification

Lifting capacity 1st layer	kg	300	500
Lifting capacity last layer	kg	185	300
Rope diameter	mm	4	5
Rope capacity 1st layer	m	3.4	2.6
Rope capacity total	m	29	22
Number of layers		6	6
Ratio		3.1:1	4.5:1
Lift per crank turn	mm	64	46
Required effort	kg	16	20
Duty class to DIN 15020		1Em	1Em
Weight	kg	5	5

Dimensions (mm)

Capacity (kg)	300	500
A	337	337
B	170	170
C	135	135
D	105	105
E1	200	200
F	83	83
F1	65	65
G	160	160
H	250	250
J	130	130
K	140	140
L	60	60
MØ	11	11
NØ	13	13

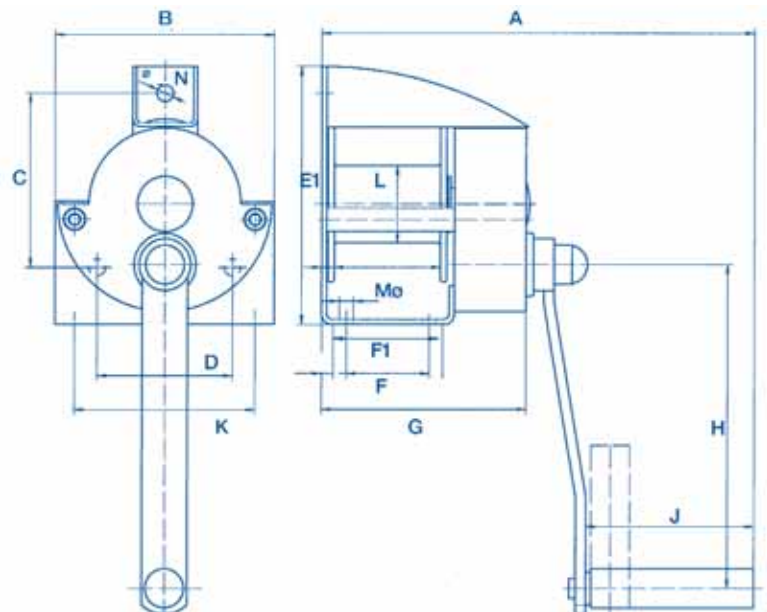

Hand Winch Type GO-CS



Lifting capacity 100 kg - 300 kg

- Compact and sturdy self sustaining lifting winches for loads up to 300 kg
- Small and inexpensive
- For base or wall mounting
- Self locking worm gear and protective cover for greater safety
- Quiet in operation; no brake ratchets
- Ideal for regular short moving strokes
- Meets the requirements of BS EN 13157

Specification

Reference		CS100	CS200	CS300	CS100PS
Winch type		Standard	Standard	Standard	Webbing
Lifting capacity 1st layer	kg	100	200	300	170
Lifting capacity last layer	kg	80	100	160	-
Rope diameter	mm	3	3 or 4	4	-
Rope capacity total	m	9	4 or 2	2	-
Capacity- webbing, 1mm thick, 20mm wide	m	-	-	-	4
Drum diameter	mm	27	27	27	27
Numbers of rope layers		8	2 or 4	2 or 4	2 or 4
Gear ratio		7:1	14:1	14:1	7:1
Lift per crank turn	mm	13	7	7	13
Required effort	kg	6	6	6	6
Minimum load for the brake function	Kg	10	10	10	10
Number of winches per box		12	12	12	12
Weight	kg	1.8	1.8	1.8	1.8

CS 100 PS is for webbing only

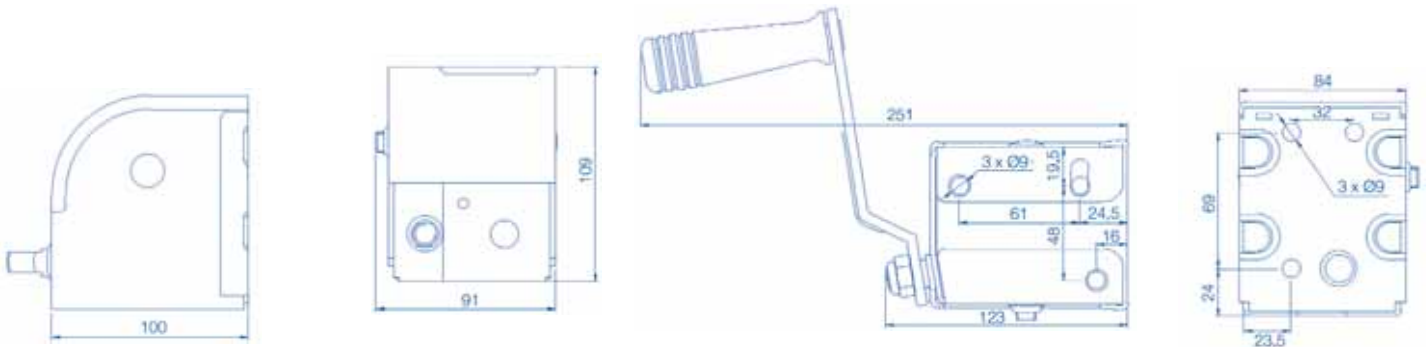

Wall mounting

Base mounting



Hand Winch Type G-WG

Lifting capacity from 250 kg to 5000 kg -
for wall mounting

- Worm gear operated winch with machine cut worm wheel and shaft mounted on bearings
- Two speed operation on 2, 3 and 5 tonne models by displacement of the crank
- Fabricated steel frame suitable for wall mounting

Options

- Electro Zinc plated protection
- Multi compartment drum
- Grooved drum
- Chain wheel drive

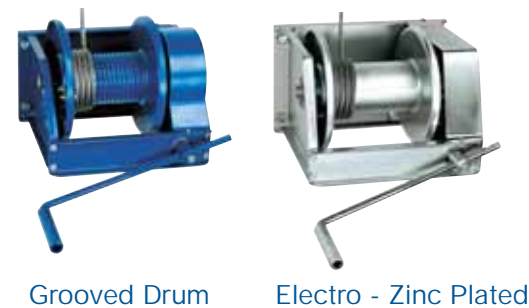
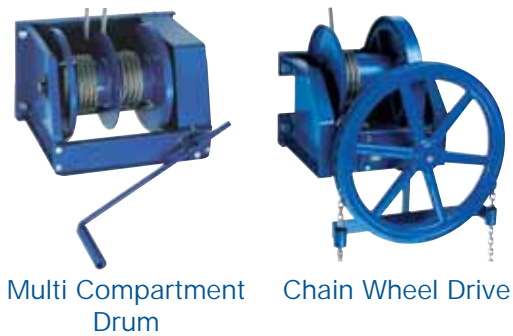
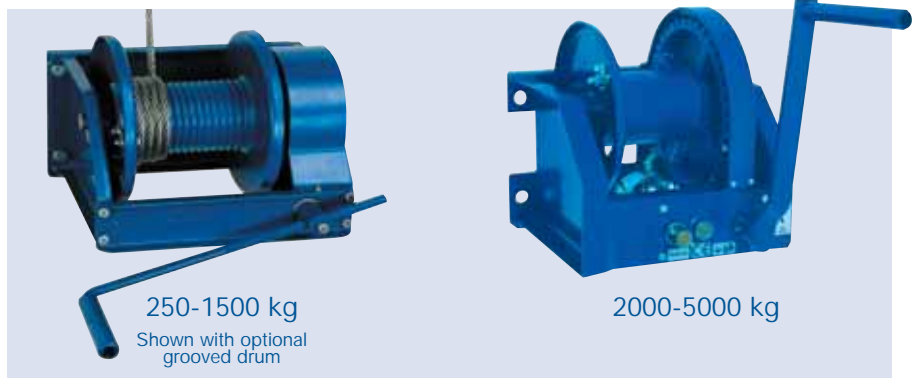

Specification

Lifting capacity 1st layer	kg	250	500	1000	1500	2000	3000	5000
Lifting capacity last layer	kg	95	239	542	845	1129	1861	3165
Rope diameter	mm	5	6	9	10	13	16	20
Rope capacity 1st layer	m	3.1	4.4	5.2	5.4	5.0	5.6	5.3
Rope capacity total	m	67	67	58	50	48	42	42
Number of layers		5	9	7	6	6	5	5
Ratio		10:1	12:1	26:1	26:1	76/38:1	104/52:1	120/60:1
Lift per crank turn	mm	17	20	23	33	11/21	8/16	9/18
Required effort	kg	5	9	14	21	9/18	12/24	25/50
Duty class to DIN 15020		1Em	1Em	1Em	1Em	1Em	1Em	1Em
Weight	kg	13	16	26	28	60	78	115

Dimensions (mm)

Capacity (kg)	250	500	1000	1500	2000	3000	5000
A	293	313	348	378	410	436	436
B	140	164	201	238	295	356	421
C	82	106	141	178	196	251	316
D	261	281	316	346	360	386	386
G	123	125	127	127	137	137	138
H	107	129	160	185	180	205	200
JØ	48	70	102	102	133	165	219
K	17	17	17	17	25	25	25
L	160	190	240	240	312	376	437
MØ	121	138	164	164	208	260	298
N	88	96	140	142	249	308	335
O	410	440	490	490	740	825	865
P	350	350	350	350	380	380	380
R	170	190	260	263	419	550	613
S	140	140	140	140	250	250	250

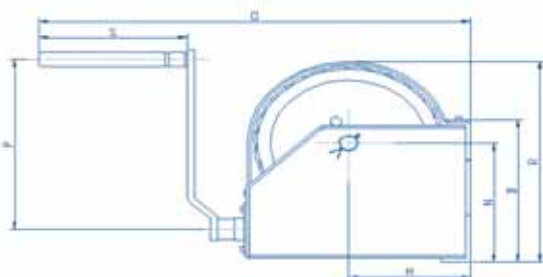

250-1500 kg

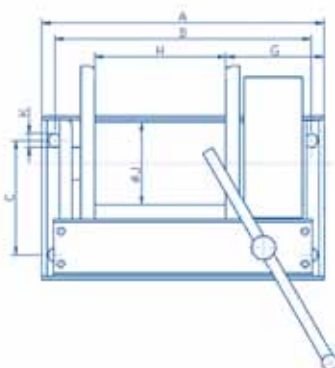
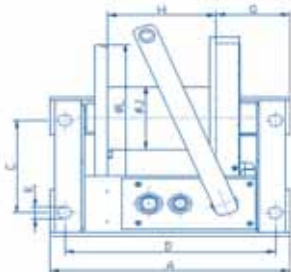

250-1500 kg

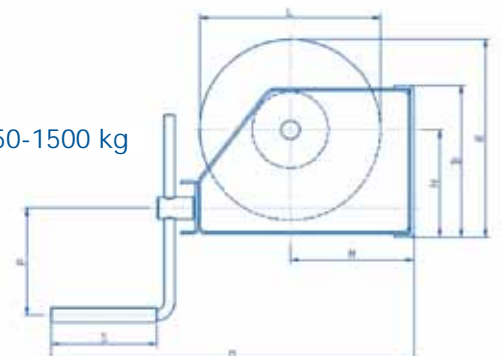



Hand Winch Type K-WB



Lifting capacity 250 kg to 750 kg for wall mounting

- Worm gear operation in an oil bath to guarantee smooth operation – very popular for theatrical applications
- Enclosed cast iron construction
- Adjustable crank radius for speedy cranking
- Self locking automatic brake ensures load is held securely
- Hardened worm shaft gives long life
- Complies with BS EN 13157

Options:

- Grease lubrication allows different mounting positions
- Grooved drums
- Multi compartment drums

Specification

Lifting capacity 1st layer	kg	250	500	750
Lifting capacity last layer	kg	210	425	624
Rope diameter	mm	5	6	8
Rope capacity 1st layer	m	4.8	7.9	9.2
Rope capacity total	m	11.3	29.1	49
Number of layers		2	3	4
Ratio		16:1	16:1	25:1
Lift per crank turn	mm	20	26	20
Required effort	kg	9.2	14.5	16
Weight	kg	12.5	21	42

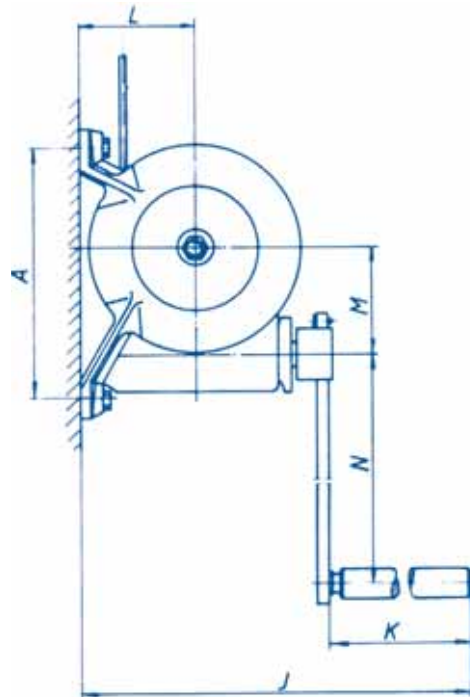

Dimensions (mm)

Capacity (kg)	250	500	750
A	205	250	330
B	137	190	243
C	120	150	205
D	85	100	125
F	219	282	350
G	94	138	182
Hø	96	125	150
J	313	479	573
K	108	238	238
L	96	112	160
M	79	101	146
N	295	440	440
O	12	14	20
P	234	290	390

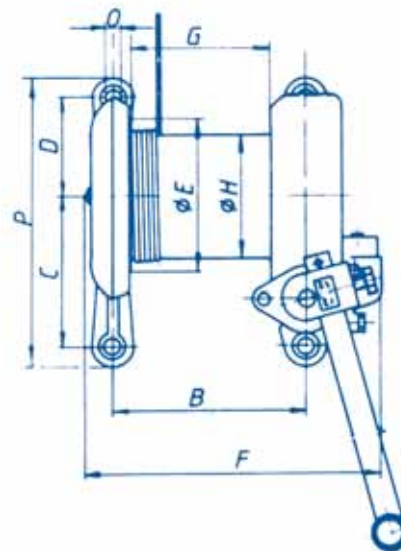



Hand Winch Type K-WB

To BGV C1 German Safety Regulation

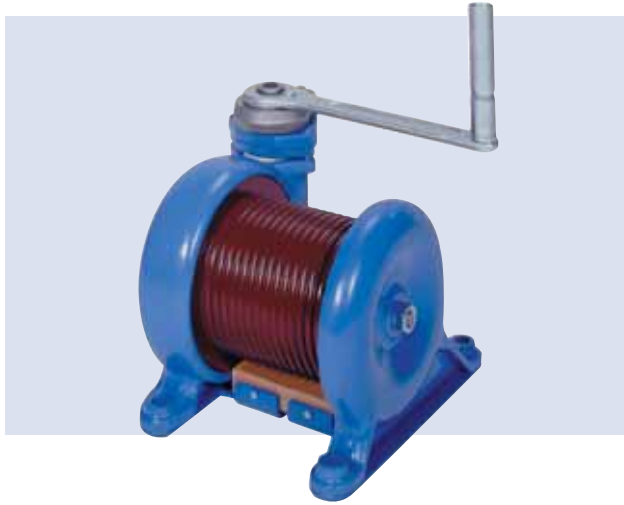

Specification

Lifting capacity 1st layer	kg	250	450	600
Drum diameter	mm	105	125	165
Drum length	mm	98	138	182
Rope diameter	mm	6	8	9
Rope capacity one layer	m	3.8	5	7.5
Lift per crank turn	mm	20	26	20
Required effort	kg	9.2	14.5	16
Weight	kg	12.5	22	40

Dimensions (mm)

Capacity (kg)	250	450	600
A	141	195	244
B	205	250	330
C	12	14	20
D	18	22	36
E	223	285	350
F	240	290	390
G	250	250	250
H	360	390	465
K	140	140	140
L	41	49	58
N	235	265	335
O	45	45	81
P	96	112	160
R	79	101	147
S	184	217	312
T	120	150	205

Lifting capacity from 250 kg to 600 kg for wall mounting

- Specially adapted winches to meet the requirements of German BGV C1 which allow loads to be lifted above people without additional safety wires
- Cast iron construction, the gears run in an oil bath; lubrication of the unit is simple – this ensures smooth operation
- With grooved rope drum, rope is held on one layer only - equipped with rope pressing device to maintain tension
- With two independent brakes each capable of holding the load
- Larger drum diameter than the standard K-WB winch (Page 18)
- Alternate mounting positions are possible with the use of a grease lubrication kit in place of oil lubrication
- Complies with BS EN 13157 standard and BGV C1 regulation

Options:

- Hand crank with folding handle
- Multi-rope operation

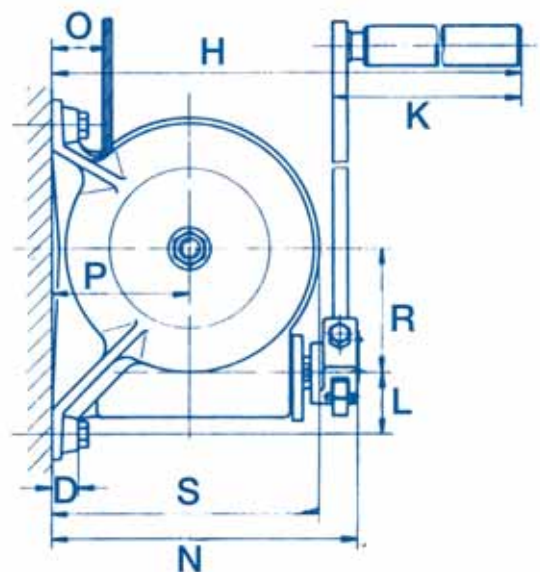
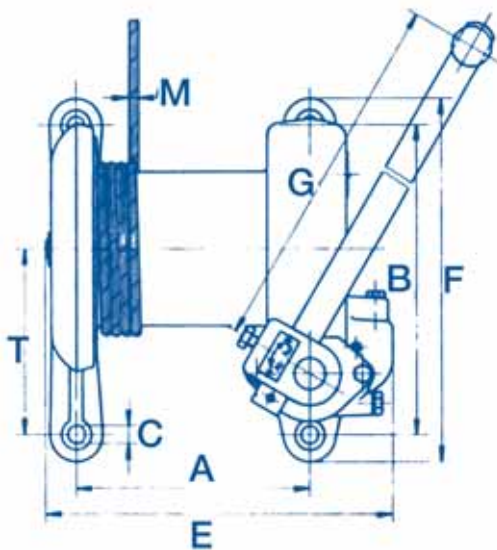



Hand Winch Type HA-WM



Lifting capacity 250 kg - 500 kg for wall mounting

- Designed for lowering spare wheels on trucks but capable of solving other problems
- A robust, inexpensive, easily operated winch
- Self locking worm gear drive, separate brake not required
- Available as standard with a fixed handle; other options available
- Suitable for outside use
- Suitable for wire or fibre rope

Specification

Lifting capacity 1st layer	kg	250	400	500
Lifting capacity last layer	kg	210	350	370
Rope diameter	mm	4	6	6.5
Rope capacity 1st layer	m	1.6	1.9	4.6
Rope capacity total	m	3.3	4	14
Number of layers		2	2	4
Ratio		25:1	25:1	25:1
Lift per crank turn	mm	5.8	7.5	13
Required effort	kg	6.6	18	14
Duty class to DIN 15020		1Em	1Em	1Em
Weight	kg	4.1	6	12

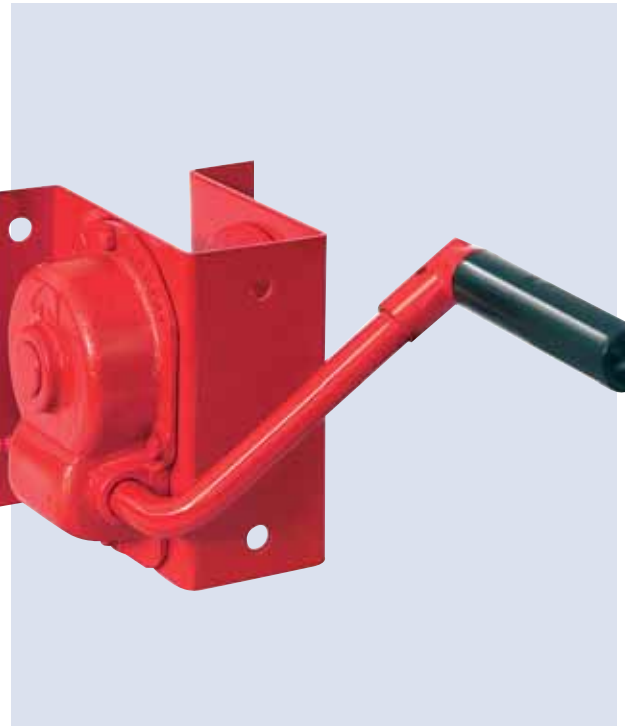

500 kg

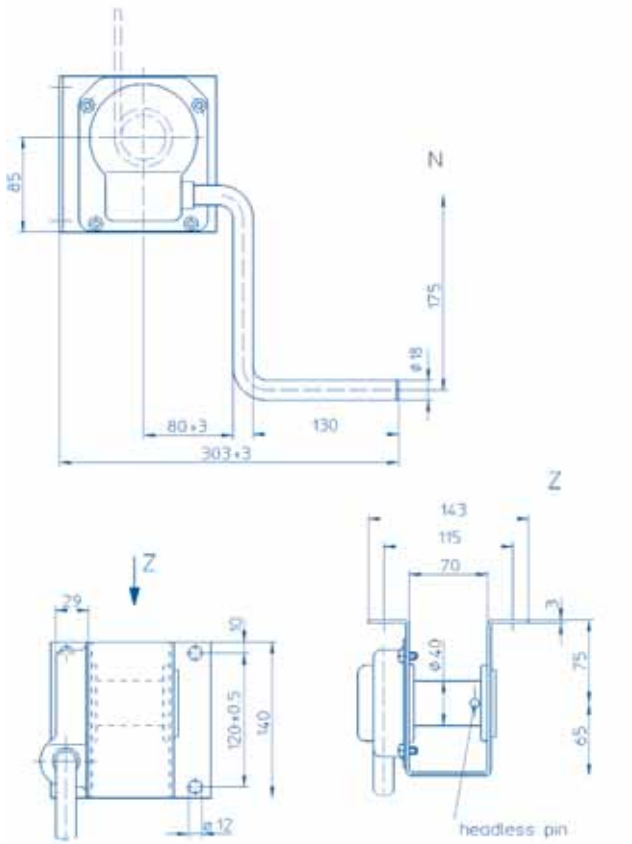

250 kg

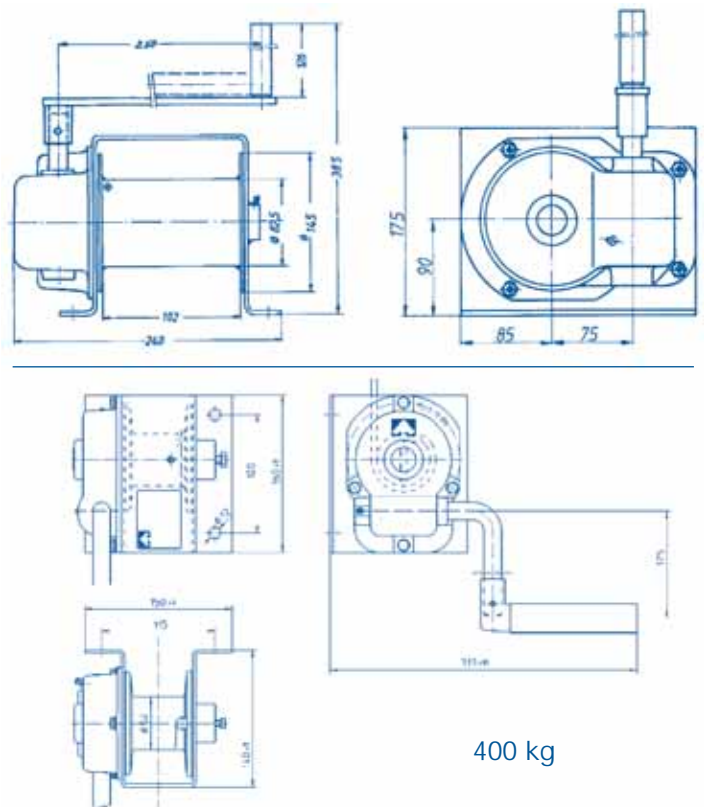

400 kg



Lashing Winch Type HA-LW



Capacity up to 2000 kg - Webbing

- Consists of a winch unit and a detachable gearbox with crank for lashing or wire rope The gearbox has a ratio of 25:1 and when connected to the winch unit winds 7.5mm per turn of crank
- Easy to use, the winch units are permanently mounted and the self locking detachable gear box is fitted when a movement is required

Specification

Lashing capacity 1st layer	kg	2000
Rope capacity total	m	9 m of 8m
Webbing capacity	m	3 of 50x5m
Ratio	25:1	
Lift per crank turn without gearbox	mm	180
Lift per crank turn with Gearbox	mm	7.5
Required effort	18	
Weight of winch	kg	6.1
Weight of gearbox	kg	3.2

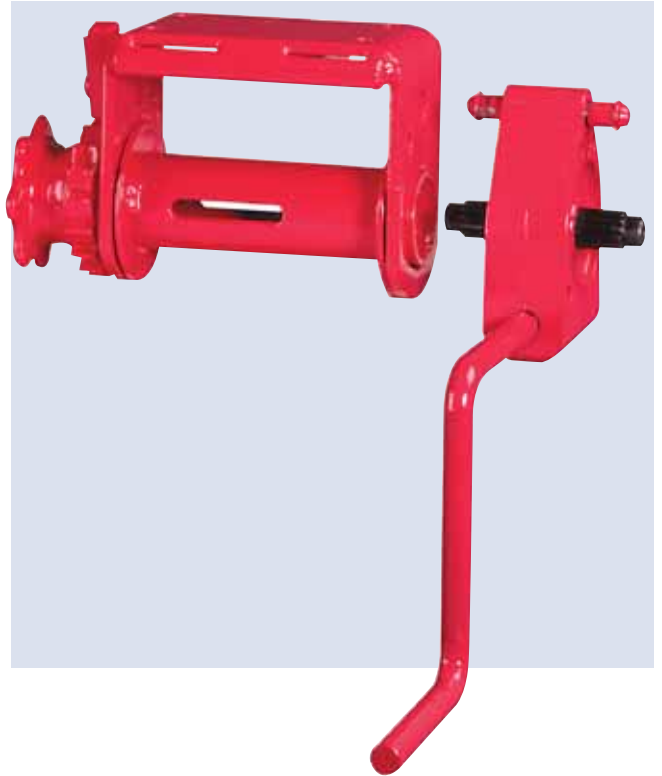

Winch Unit

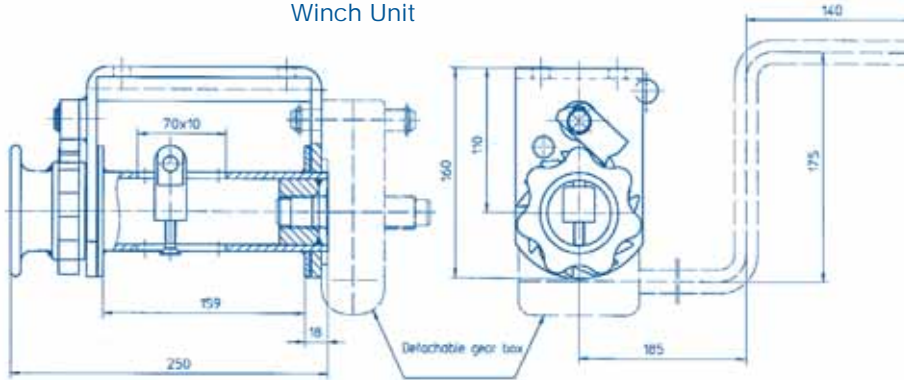

Gearbox Unit

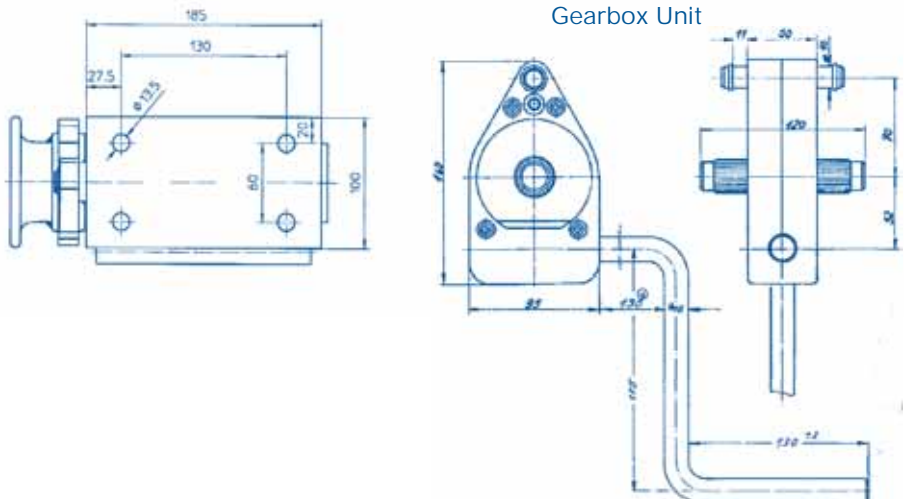



Electric Winch Type HD-EL

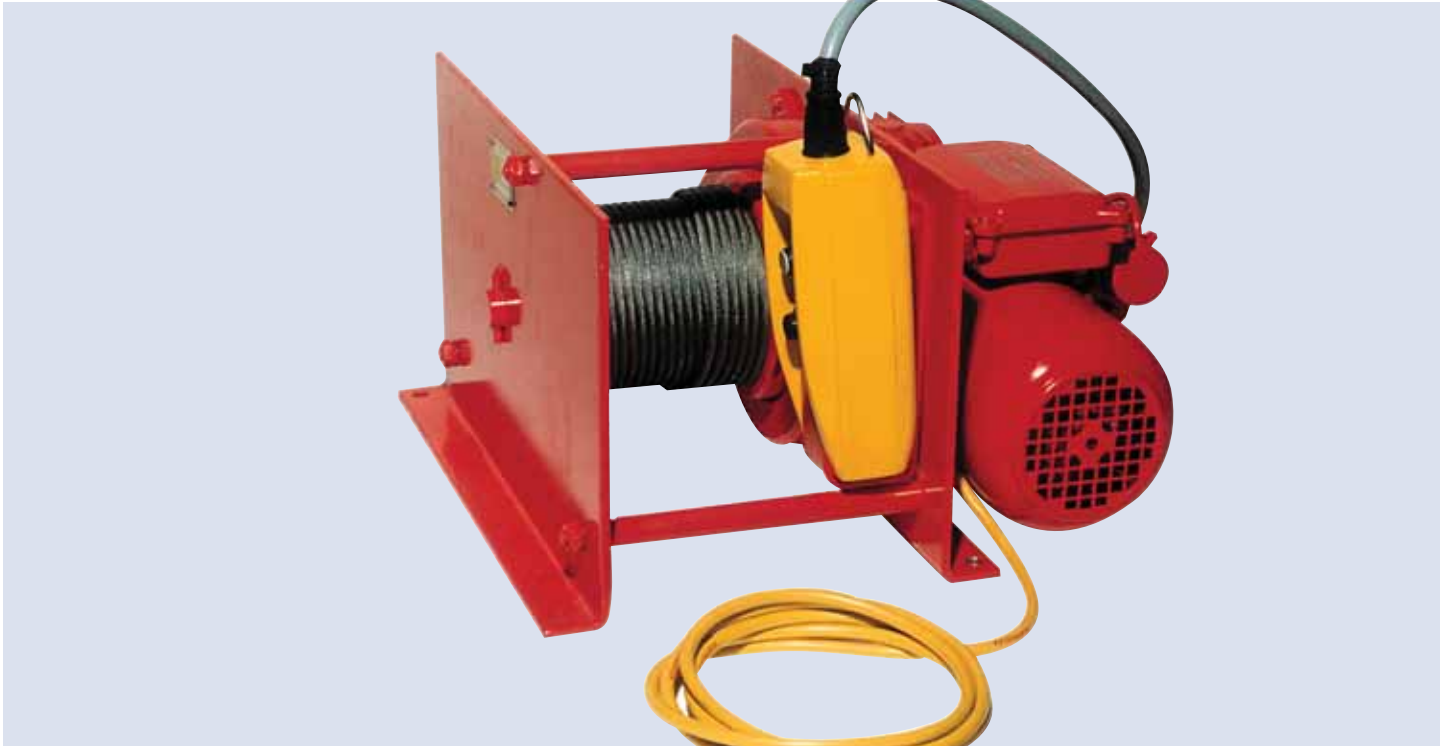

Lifting capacity 125 kg -2000 kg

- Compact and robust design
- Power supply 400V, 3 phase, 50Hz or 220V, 1phase, 50Hz
- Enclosure IP54 protection, Insulation class B
- Overload protection from 1000 kg and above

Options

- Low voltage controls
- Pendant or wall mounted control switch
- Grooved rope drum
- Travel limit switches
- Disengaging clutch
- Dual hoisting speeds

Specification - Electric Winch - 400V, 3Ph, 50Hz

	kg	125	250	500	990	1000	2000
Lifting capacity 1st layer	kg	125	250	500	990	1000	2000
Lifting capacity last layer	kg	90	180	340	780	780	1560
Number of layers		4	4	4	3	3	3
Rope diameter	mm	4	4	6	8	8	11
Rope capacity 1st layer	m	6.4	7.1	5.7	8.4	8.4	8.0
Rope capacity total	m	32	35	30	30	30	30
Rope speed	m/min	11	7	4	6	6	6
Motor output	kW	0.37	0.37	0.37	1.3	1.3	2.6
Current	A	1.1	1.1	1.1	3.2	3.2	6.0
Duty class to DIN 15020 FEM		1Bm	1Bm	1Bm	1Bm	1Bm	1Bm
Weight	kg	25	35	38	80	80	150



Electric Winch Type HD-EL



Specification - Electric Winch - 220V, 1Ph, 50Hz

Lifting capacity 1st layer	kg	125	125	250	250	500	500	990	1000	2000
Lifting capacity last layer	kg	90	90	180	180	340	340	780	780	1560
Number of layers		4	4	4	4	4	4	3	3	3
Rope diameter	mm	4	4	4	4	6	6	8	8	11
Rope capacity 1st layer	mm	6.4	6.4	7.1	7.1	5.7	5.7	8.4	8.4	8
Rope capacity total	mm	32	32	35	35	30	30	30	30	30
Rope speed	m/min	11	22	7	14	4	8	6	6	6
Motor output	kW	0.37	0.75	0.37	0.75	0.37	0.75	1.3	1.3	1.3
Current	A	4.0	5.2	4.0	5.2	4.0	5.2	9.1	9.1	9.1
Duty class to DIN 15020 Fem rating		1Bm	1Bm	1Bm	1Bm	1Bm	1Bm	1Bm	1Bm	1Bm
Weight	kg	27	25	37	35	40	38	88	88	150

Dimensions (mm)

Capacity (kg)	125	250	500	990	1000	2000
A1	205	260	260	345	345	440
A2	165	165	165	216	216	216
A2 Single phase	195	195	195	240	240	240
A3	171	222	222	289	289	358
A4	35	34	34	45	45	61
A4 With limit switch	237	237	237	300	300	300
A5	43	78	82	97	97	171
A6	135	150	145	200	200	200
A7	27	32	33	48	48	69
A8	13	15	15	17	17	20
B	405	405	405	575	575	600
B Side plate bearing side	230	-	-	-	-	-
B1	375	375	375	535	535	550
B1 Side plate bearing side	200	-	-	-	-	-
C	215	250	250	270	270	385
C1	140	140	140	155	155	171
C2	4	6	6	10	10	15
D	60	60	76	108	108	146
D1	130	150	150	180	180	245
D2	9	11	11	13	13	17

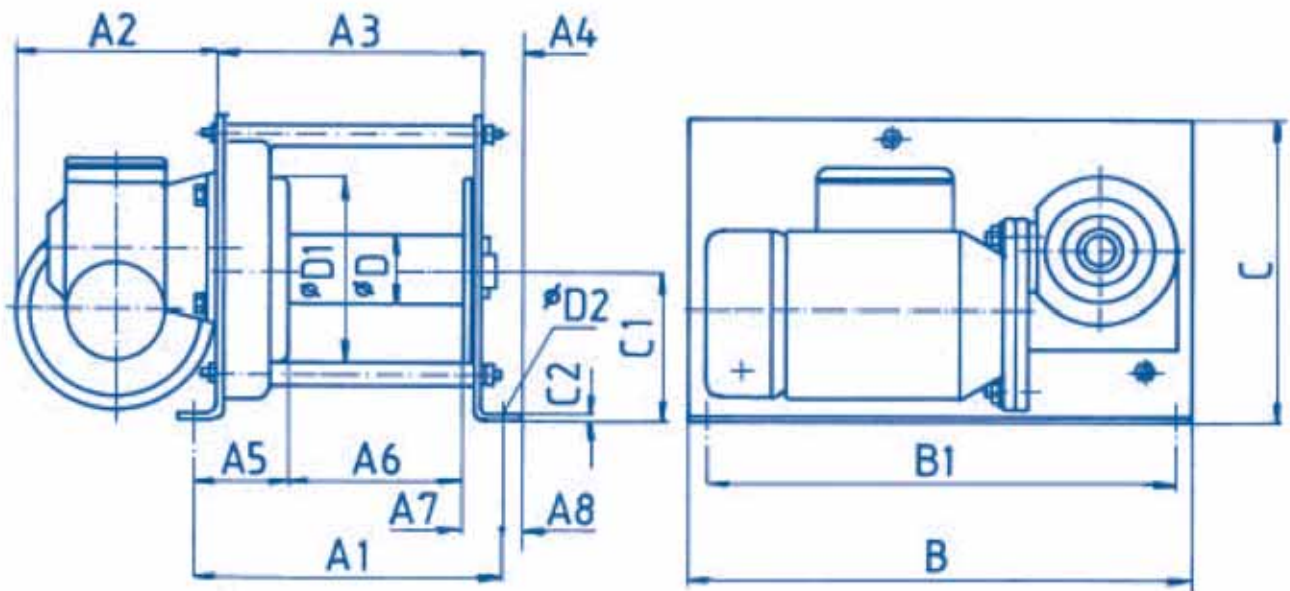



Electric Winch Type HD-EW



Lifting capacity 500 kg -10,000 kg

- Robust design, lifetime-lubricated bearings
- High safety factor with low maintenance requirement, overload protection from 1000 kg and above

• Quiet in operation

Standard model

- Ungrooved rope drum
- Low voltage 42V control installed for external control pendant or wall mounted box
- Connection provided for external limit switch
- Power Supply 400V, 3Ph, 50Hz - IP 54 enclosure

Options

- Alternate power supply
- Alternate rope speeds
- Rope drum extension
- Grooved rope drum including grooving for 1 or 2 ropes
- Additional flanged wheels on the drum for two or more ropes
- Limit switches
- Slack rope switch (available up to 12mm Ø rope)
- Two rope speeds
- Disengaging clutch to allow fast rope unwinding

Specification

Lifting capacity 1st layer	kg	500	500	990	990	1000	1000	2000	2000	3200	5000	7500	10000
Lifting capacity last layer	kg	330	330	730	730	730	730	1400	1400	2130	3325	5030	7265
Rope speed 1st layer	m/min	6	16/4	6	16/4	6	16/4	6	16/4	8/2	6/1.5	5.5/1.4	4/1
Rope speed last layer	m/min	9	24/6	8	23/5.8	8	23/5.8	9	23/5.8	13/3.3	8/2	8/2	6/1.5
Rope capacity 1st layer	m	28	28	30	30	30	30	36	36	35	39	54	57
Rope capacity total	m	183	183	151	151	151	151	231	231	234	263	358	288
Rope diameter	mm	6	6	9	9	9	9	12	12	16	20	24	28
Number of layers		5	5	4	4	4	4	5	5	5	5	5	4
Motor output	kW	0.55	1.5/0.37	1.1	3/0.75	1.1	3/0.75	2.2	5.5/1.4	5.5/1.4	5.5/1.4	7.5/1.9	7.5/1.9
Current	A	1.45	3.7/1.8	2.6	6.6/3.0	2.6	6.6/3.0	4.9	13/5.6	12.5/5.9	12.5/5.9	17.5/7.2	17.5/7.2
Weight	kg	80	90	110	130	110	130	250	280	390	950	1400	1900

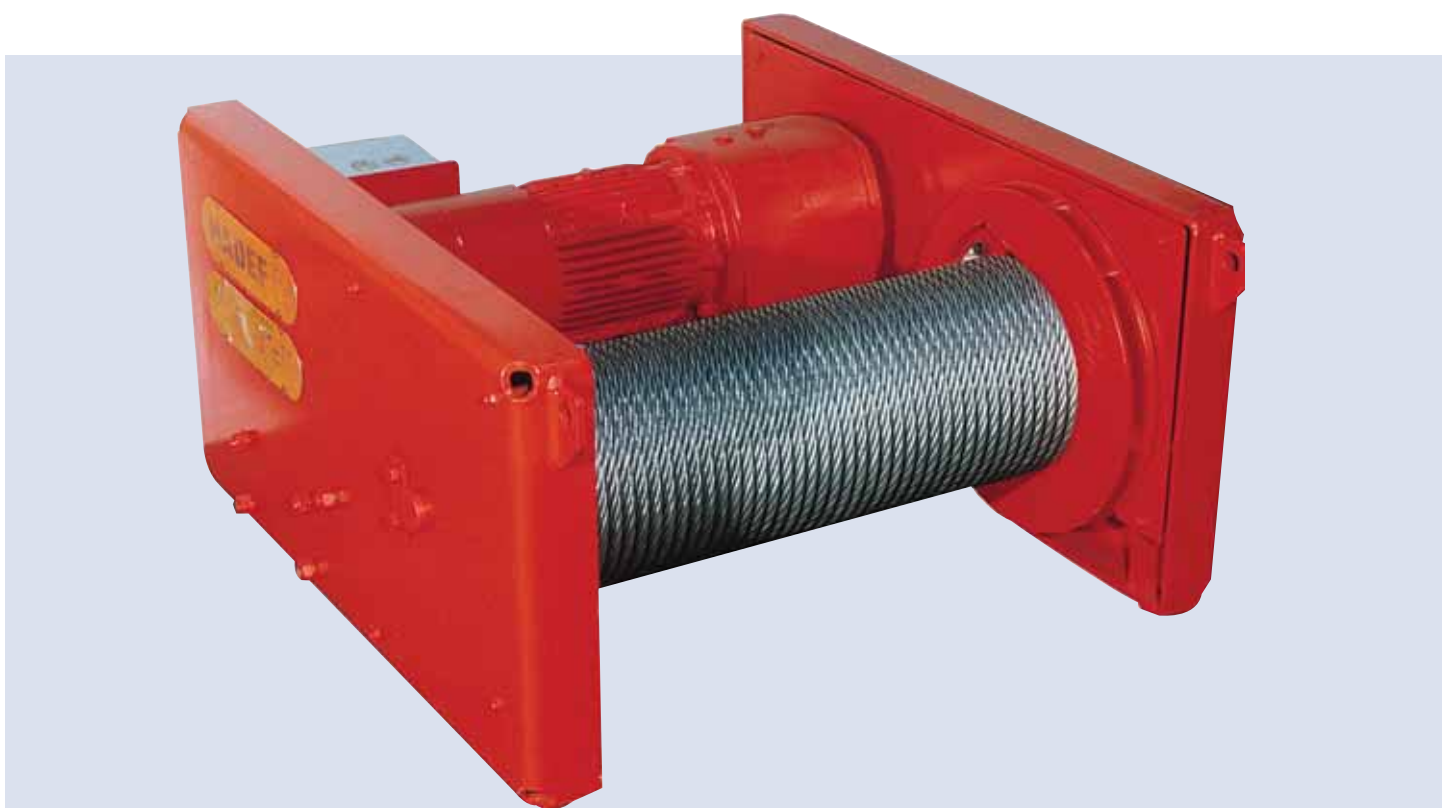



Electric Winch Type HD-EW



Dimensions (mm)

Capacity (kg)	500	990	1000	2000	3200	5000	7500	10000
A	700	800	800	830	990	1100	1416	1540
A1	650	720	720	750	900	1000	1300	1410
A2	590	620	620	645	750	850	1130	1225
A3	142	236	236	180	20	20	25	25
A3 Outer edge to limit switch	-	-	-	-	235	235	235	235
A4	95	95	95	130	160	160	150	150
A5	25	40	40	40	45	50	58	65
A6	40	70	70	70	90	90	102	115
B	470	660	660	805	995	1115	1415	1540
B1	400	580	580	725	900	1000	1300	1430
B2	234	322	322	385	435	535	635	703
B3	120	180	180	245	260	285	410	457
B4	0	50	50	50	70	70	70	70
B5	35	40	40	40	47.5	57.5	57.5	55
B6	-	-	-	-	-	-	100	100
B7	120	120	120	120	120	120	120	120
C	276	356	356	446	528	593	745	810
C1	141	181	181	226	268	300	378	410
D	89	140	140	216	241	298	368	419
D1	167	245	245	370	450	560	685	750
D2	11	17	17	17	24	30	26	30
D3	0	25	25	25	40	40	40	40

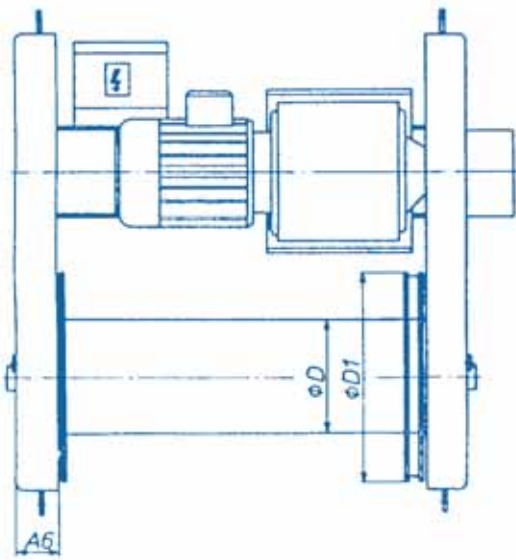
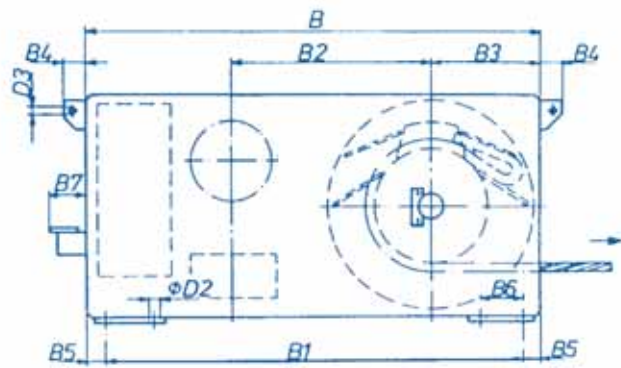
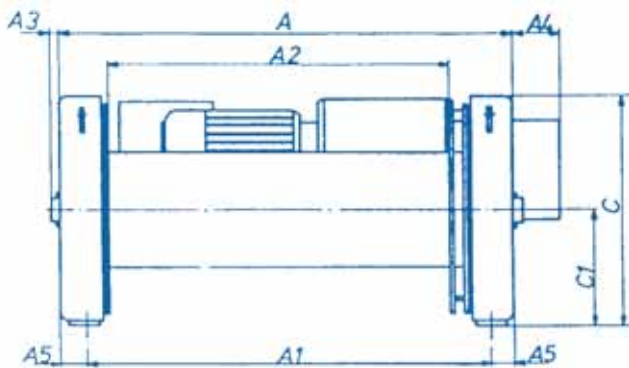



Type 1a - With Bronze Bush

Cast iron with bronze bush for assembly into brackets.

Specification & dimensions (mm)

Capacity (kg)	500	1000	2000	3000
D	100	125	150	200
D1	80	100	125	170
dL	19	22	30	40
dN	40	42	60	70
IN	23	24	29	40
b	21	22	26	37
b1	14	16	18	26
R	6	6.5	7	10
Max rope diameter	10	12	13	18
Weight (kg)	0.6	0.9	1.7	3.7

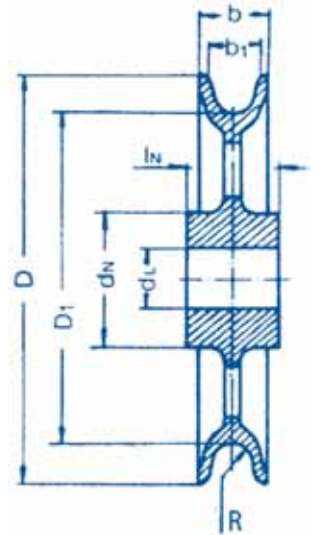

Type 2 - Without Bush

Simple inexpensive design for use with manual winches only.
Material - cast iron with plain bearing and grease nipple.
Complete with fixing bracket.

Specification & dimensions (mm)

Capacity (kg)	250	750	1000
Capacity 90° rope diversion (kg)	125	500	750
Wire rope diameter (mm)	3-6	6-8	8-12
A	140	200	250
B	85	120	145
C	100	100	210
D	128	140	245
E	14	14	22
F	64	78	84
G	9	13	17
H	100	140	185
Weight (kg)	2.5	5.5	12.5

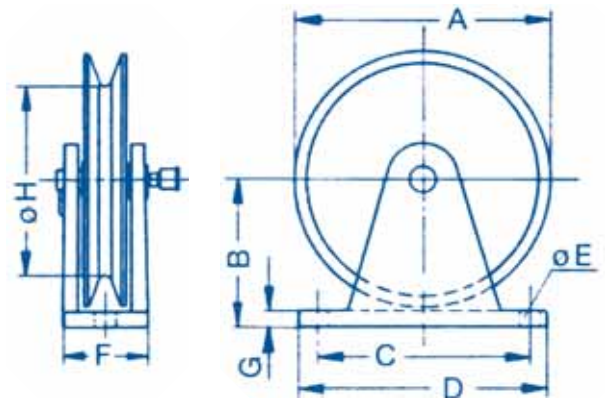

Stainless Steel Wire Rope Pulleys

A 500 kg rope pulley complete with bracket, in Stainless Steel, for use in aggressive environments.



Dimensions (mm)

Capacity (kg)	500
A	100
B	80
C	60
D	150
F	100
G	10
H	62
J	14
K	30

Specification

Capacity	500 kg
Materials	Stainless Steel V2A
Wire rope diameter	5-6mm
Weight	2 kg

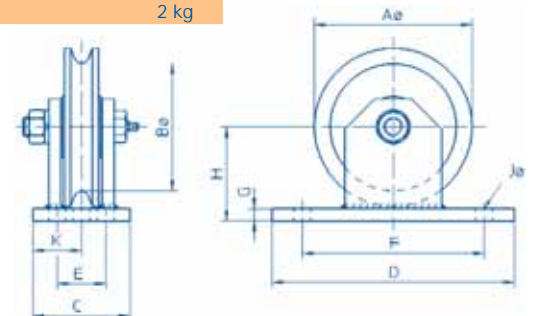

Gearbox Type HA-GB

Output torque 200 - 1800 Nm

- Hand driven all purpose gear drive for multiple applications including winches and jacks etc
- Motor drive possible for speed up to 100 revolutions/min
- Crank with internal self actuating load brake
- Maintenance free, robust and reliable

Options

- Winch drum

Specifications

Output torque	nm	200	600	1200	1800
Required effort	kg	24	19	32	30
Ratio		6.4:1	18.5:1	25.7:1	42.8:1
Weight	kg	8	10	18	24

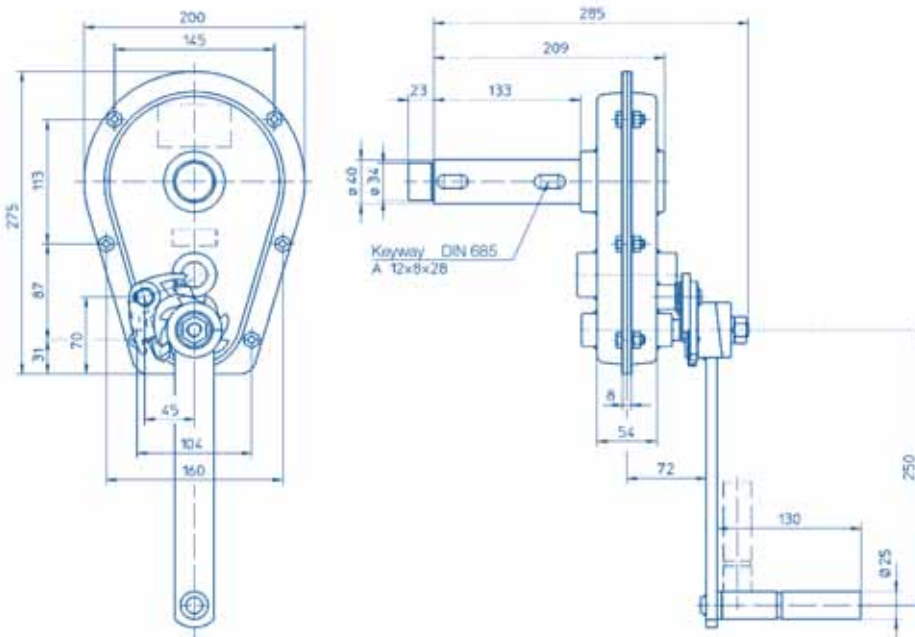

200 nm Gearbox.
Drawings of other 3 units are available on request



Braked Safety Crank



A range of safety cranks used when hand-driven mechanisms require a brake and handle; examples are specially designed winches or jacks.

Available in unpainted, painted or plated finish.

Available in Stainless Steel – SIN type.

DS 250 Crank

Available in Unpainted, Painted or Plated Finish

Steel crank with folding handle, spring operated load pressure brake which is silent in operation and weather resistant if regularly greased.

Crank has infinitely adjustable lifting position with very responsive brake initiation.

It does not require a separate ratchet assembly.

- Radius – 250mm
- Square drive of either 14mm or 17mm
- Braking torque – 70 Nm

DSK 250 Brake

Available in Unpainted, Painted or Plated Finish

This is a brake hub unit from the DS 250 without crank designed for use with shaft driven equipment

- Also available for motorised actuation at low speed

Siku Crank: S250/S300

Available in Unpainted, Painted or Plated Finish

The crank is used with a spring loaded double acting ratchet assembly (not shown), suitable for indoor or outdoor applications on request.

The crank is of forged steel with folding handle and incorporates two conical nylon or brass brake discs which act as a friction assembly, dependant on the duty required and the application.

Two units are available with 250mm or 300mm radius cranks.

- S250: 14 or 17mm square mounting – 70 Nm Torque
- S300: 14 or 17mm square mounting – 168 Nm Torque

SIN 250 Crank

Stainless Steel

This crank is in Stainless Steel material and works with a separate single part ratchet assembly

It is suitable for lightly loaded applications such as hand winches

The crank has either a 14 or a 17mm square mounting hole and a 250mm radius crank

- Rated torque: 70 Nm





Winch Drive Group/Duty Class - To DIN 15020 Part 1

RUNNING TIME CATEGORY (running time per day in hours, related to one year)	LIGHT Max load occurs only infrequently.	MEDIUM Low, average. max load occurs with roughly equal frequency.	HEAVY Max load occurs almost continuously.
V006 up to 0.125	1Em	1Em	1Dm
V012 over 0.125 - up to 0.25	1Em	1Dm	1Cm
V025 over 0.25 - up to 0.5	1Dm	1Cm	1Bm
V05 over 0.5 - up to 1	1Cm	1Bm	1Am
V1 over 1 - up to 2	1Bm	1Am	2m
V2 over 2 - up to 4	1Am	2m	3m
V3 over 4 - up to 8	2m	3m	4m
V4 over 8 - up to 15	3m	4m	5m
V5 over 15	4m	5m	5m

If the duration of an operating cycle is 12 minutes or longer, the rope may be graded one drive group lower than the drive group grading determined from the running time category and from the load collective.

Calculating Fleet Angle

Minimum distance from drum to first sheave or load connection - metres

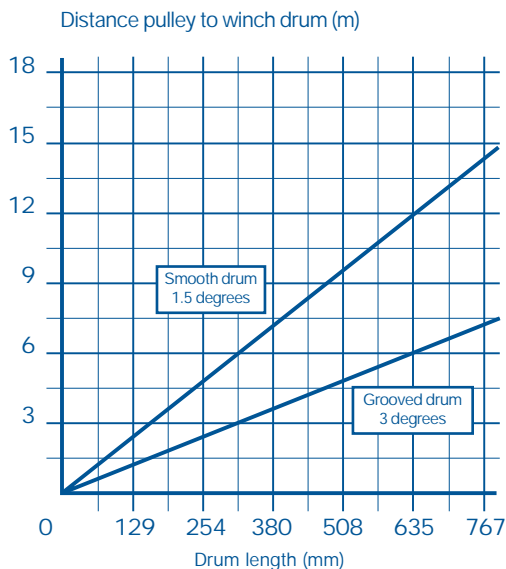
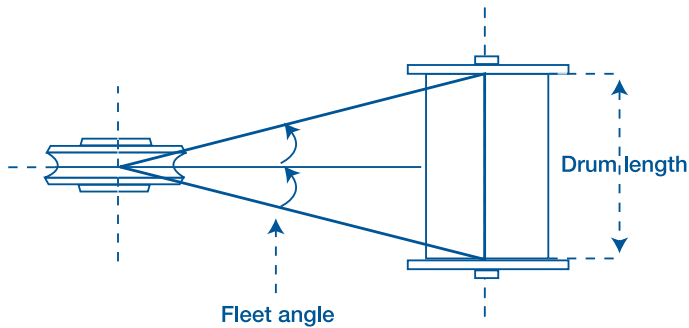

Slope & Grade Resistance

SLOPE (Percent per 100 Horizontal m) %	GRADE RESISTANCE (kg pull per ton to overcome grade resistance)
1	9
2	18
3	27
4	36
5	45
6	54
7	63
8	73
9	82
10	90
11	99
12	108
13	117
14	126
15	134
16	143
17	151
18	160
19	169
20	178
25	220
30	260
35	299
40	337
45	372
50	406
55	437
60	464
65	492
70	519
75	543
80	565
85	587
90	607
95	624
100	638



Rack & Pinion Jack

with self-locking worm gear



Rack & pinion jack for lifting, lowering, adjusting and fixing of mechanical components, devices, machines, etc.

Extremely easy functioning, self-locking worm gear

Fixed folding handle or removable handle (type 1524)

Robust version with milled rack and hardened gears, for indoor and outdoor applications

Special versions against additional charge:

- an other lift or length
- an other crank version
- an other fixing possibility
- an other surface treatment



Rack & Pinion Jack

with self-locking worm gear

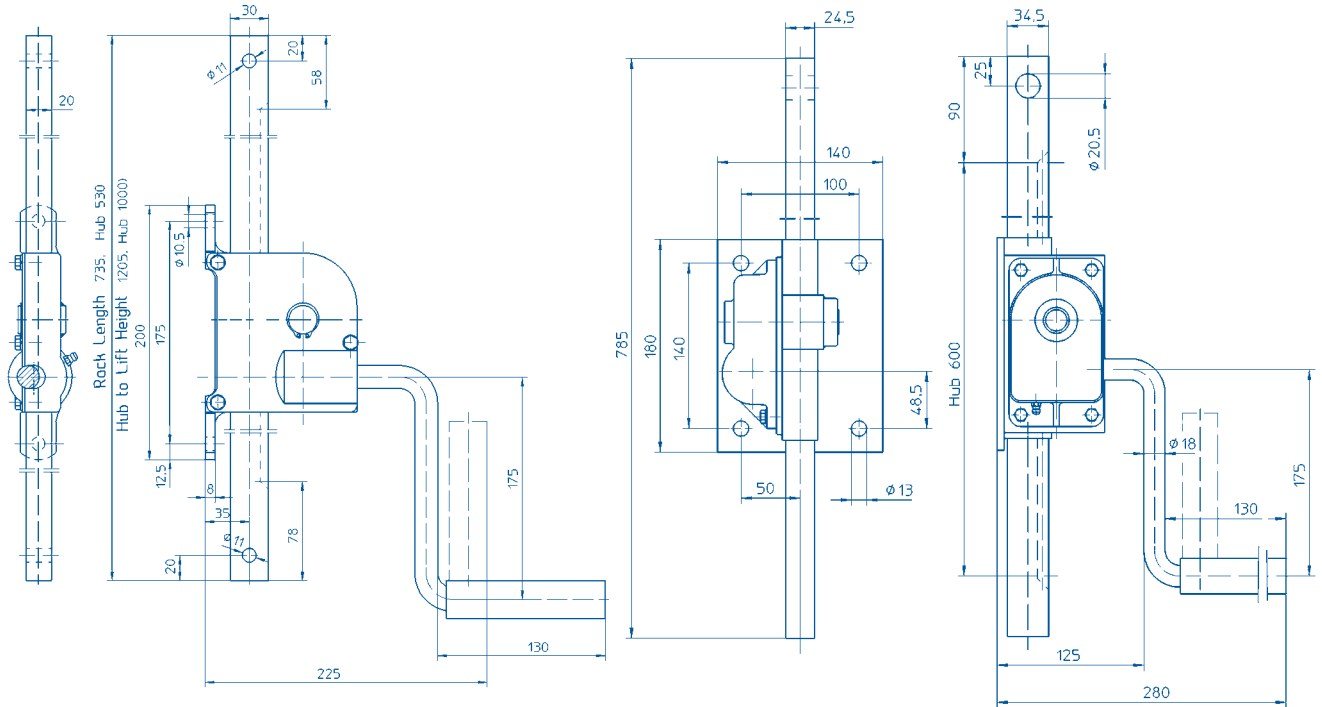

500 kg Jack

1000 kg Jack

Specification

Type	lift	Rack length	Material
1524.0,5	530	735	cast iron, steel
1524.0,5	530	735	stainless steel
1524.0,5	1000	1205	cast iron, steel
1524.0,5	1050	1225	cast iron, steel
1524.0,5	1000	1205	stainless steel
1555.1	600	785	cast iron, steel
Technical data		1524.0,5	1555.1
permissible load		0,5 t	1 t
overall height		735 / 1205 mm	785 mm
lift		530 / 1000 mm	600 mm
gear ratio		1 : 20	1 : 18
lift/ crank turn		9,4 mm	3,5 mm
crank force	160 N	160 N	
weight	5,7 / 7,7 kg	9 kg	



Rack & Pinion Jack 1624 / 1685



Rack & pinion jack for easy and secure lifting lowering, adjusting, etc. of all kinds of charges.

Self-locking security crank, keeps the charge in every required position
easy and effective operation through optimal gear ratio

For pulling or pushing

Load: 1,5 - 10 t

Special versions on request:

- different length of rack
- different lift
- drive shaft to connect several jacks
- with internal brake and removable crank



Rack & Pinion Jack 1624 / 1685

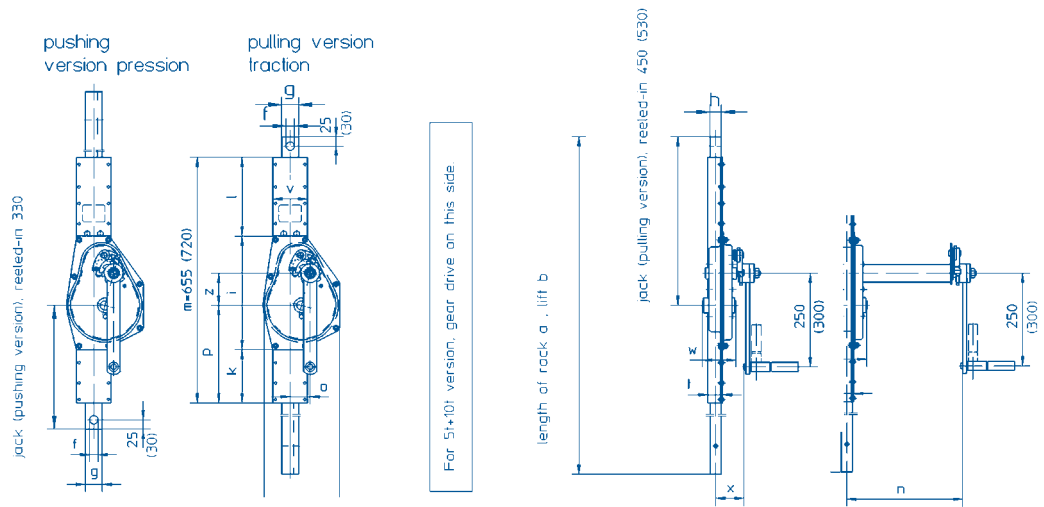

Specification

Dimensions in brackets are valid for jack with admissible load of 10t.

Tload t	version Pushing or Pulling?	rack length mm	lift mm	lift/crank turn mm
1,5 t	pulling version	1350	800	13,9
1,5 t	pulling version	1805	1250	13,9
1,5 t	pulling version	2055	1500	13,9
1,5 t	pulling version	2355	1800	13,9
1,5 t	pushing version	950	400	13,9
1,5 t	pushing version	1350	800	13,9
1,5 t	pushing version	1805	1250	13,9
1 t	pushing version	2055	1500	13,9
0,75 t	pushing version	2355	1800	13,9
3 t	pulling version	1350	800	8,0
3 t	pulling version	1800	1250	8,0
3 t	pulling version	2350	1800	8,0
3 t	pushing version	950	400	8,0
3 t	pushing version	1350	800	8,0
2,5 t	pushing version	1800	1250	8,0
1 t	pushing version	2350	1800	8,0
5 t	pulling version	1405	800	3,9
5 t	pulling version	2400	1800	3,9
5 t	pushing version	1000	400	3,9
5 t	pushing version	1405	800	3,9
3 t	pushing version	2400	1800	3,9
10 t	pulling version	1450	800	4,0
10 t	pushing version	1450	800	4,0

Dimensions

	1,5 t	3 t	5 t	10 t
f	20.5	22.5	26	31
g	35	45	50	60
h	25	30	40	50
i	195	303	308	396
k	200	142	163	125
l	260	210	184	199
n	400	410	420	430
o	43.5	53	69.5	49
p	270	260	260	255
t	33.5	39.5	51	62.5
u	125	204	189	250
v	78	89	104	132
w	78	89	104	132
x	67	77	88	104
z	42.5	86	109	150.5



Single Sluice Gate Drive



Single Sluice Gate Drives to open and close sluice gates on canals and rivers.

- internal self-actuating brake keeps the charge in every required position
- easy and effective operation through optimal gear ratio
- for manual operation and power drive
- Load: 1 - 6 tonnes
- Dimensions individually adjusted to your requirements

Options:

- Rack with protective cap
- Rack covered with fixed protective tube
- Various surface protection
- Control

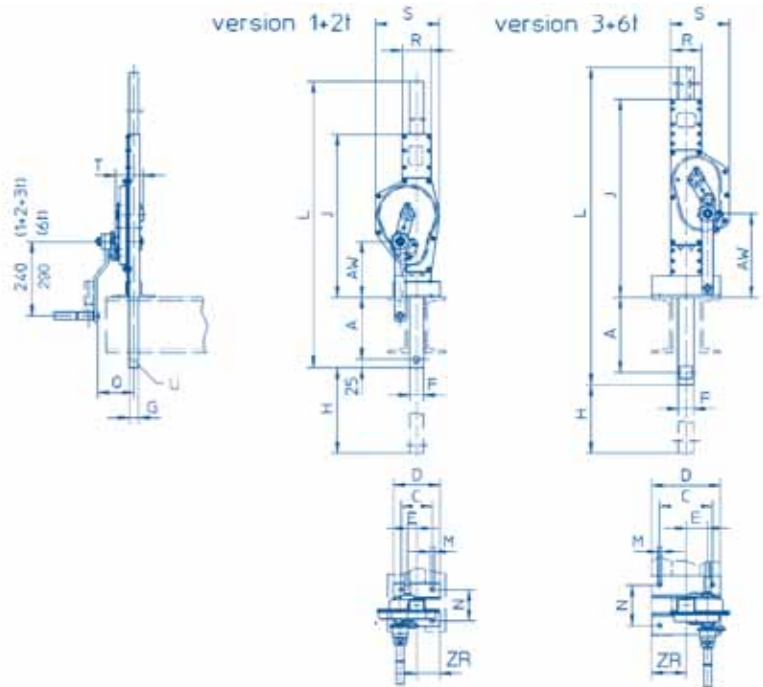

Specification

	1212.1	1212.2	1212.3	1212.6	
Pulling force	10	20	30	60	kN
Pushing force	10	20	30	30	kN
Gear ratio inside of jack	4,5	9,5	22,5	24,7	i
Crank force at max. pulling force	50	160	130	230	N
Lift / crank turn with side operation	13,9	8	3,9	4	mm
Lift, motor operated aacon/Auma	973/876	560/604	273/246	280/252	mm/min
Rack weight	6,5	10	14,5	22	kg/m
Weight w.o. rack	9	12	17	25	kg

Dimensions (mm)

Type	A	C	D	E	F	G	J	H	L	M	N	Q	R	S	T	U	AW	ZR
1212.1	200	100	150	44	35	25	492	800	1520	13	94	100	78	125	80	20,5	180	75
1212.2	200	100	150	53	45	30	526	1000	1755	13	100	112	92	205	89	22,5	180	75
1212.3	250	170		220	70	50	639	1250	2170	13	131	125	100	189	109	26	270	110
1212.6	250	200	250	89	60	50	676	1500	2460	21	143	140	132	250	132	31	270	125



Double Sluice Gate Drive



Double Sluice Gate Drives to open and close sluice gates on canals and rivers.

- high security standard through encased gear drive and internal brake
- easy and effective operation through optimal gear ratio
- side or angular gear operation
- Load: 5 - 20 tonnes, coupled devices up to 40 t
- for manual operation and power drive
- Dimensions individually adjusted to your requirements

Options:

- Rack with protective cap
- Rack covered with fixed protective tube
- Various surface protection
- Control

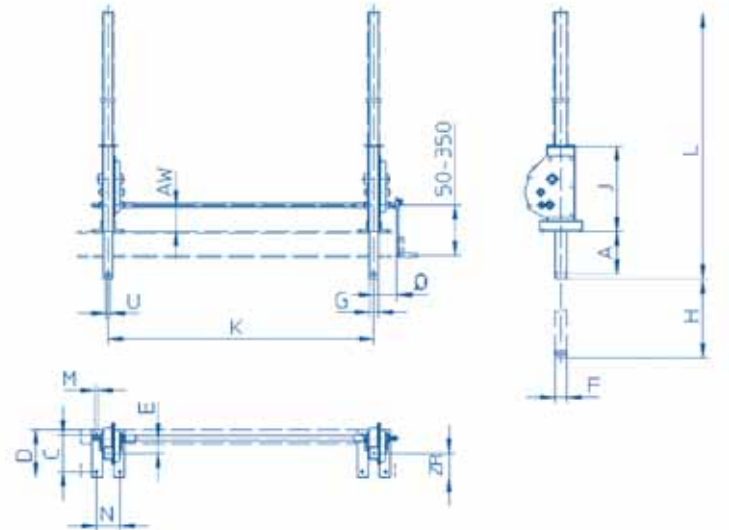

Specification

	1285.8	1285.12	1285.20	
Pulling force	80	120	200	kN
Pushing force	40	60	100	kN
Gear ratio inside of jack	36,3	47,5	98,4	i
Crank force at max. pulling force	270	300	280	N
Lift / crank turn with side operation	2,5	2,1	1,15	mm
Lift, motor operated aacon/Auma	175/225	147/185	91/104	mm/min
Rack weight	14,5	22	26	kg/m
Weight w.o. rack	62	86	112	kg

Dimensions (mm)

Type	A	C	D	E	F	G	H	K	L	J	M	N	O	U	AW	ZR
1285.8	240	200	250	52	50	40	1250	1975	455	21	140	160	26	180	125	
1285.12	240	200	250	58	60	50	1500	2240	465	21	140	170	31	180	125	
1285.20	240	200	250	63	75	50	1750	2545	510	21	144	170	41	180	125	

liftturnmove

LTM-LIFT TURN MOVE LIMITED

UNIT 6, APPIN ROAD
ARGYLE INDUSTRIAL
ESTATE
BIRKENHEAD
MERSEYSIDE
CH41 9HH
UK

TEL: +44 (0)151-649-0467
FAX: +44 (0)151-649-0099
WWW.WINCHSHOP.CO.UK
SALES@WINCHSHOP.CO.UK

LTM 'THE WINCH PEOPLE'

